



**YORK  
REGION**

Kittery  
Eliot  
York  
South Berwick  
Cape Neddick

Chamber of Commerce

Canyondlands National Park

# Utah's Mighty National Parks

Featuring Five Nights in Moab Utah

June 16, 2022

7 DAYS

**BOOKING  
DISCOUNT!**

Save \$200 Per Person  
\$400 Per Couple\*

**NO RISK DEPOSIT  
NO CHANGE FEES**

Book Now and your Deposit is Risk Free with  
No Change Fees until Final Payment Due Date!  
See back for details\*\*



**TOUR RATES:**

Booking Discount\*: **\$3049** pp double

Regular Rate: **\$3249** pp double

Single Supplement: +\$995

\*See Reservation Info for Booking Discount details

\*\*Chamber Member save an additional \$100 per person





Deadhorse Point State Park



Colorado River Jet Boat Tour



Arches National Park

# Utah's Mighty National Parks *Featuring Five Nights*

## DAY 1: ARRIVE GRAND JUNCTION COLORADO

Upon arrival meet your Tour Director and transfer to your hotel. The 'River City' extends a warm welcome as your gateway to an in-depth encounter to explore Utah's National Parks. Enjoy a **Welcome Dinner** this evening and get acquainted with your traveling companions.

ⓧ (D) Overnight: **Grand Junction, CO**

## DAY 2: GRAND JUNCTION - MOAB

Depart Grand Junction for Moab Utah with a stop to see the **Colorado National Monument** along the Rim Rock Drive. Travel along **Scenic Byway 128** referred to by locals as the River Road and one of the most beautiful and breathtaking drives imaginable. Travel through canyons carved by the Colorado River and see the iconic Fisher Towers, towering cliffs and mesas, incredible rock formations, beautiful ranch resorts, painted canyons and enough red rock to overload the senses. Check into your hotel in Moab and unpack for a **five-night stay**. Later

enjoy a Colorado River Cruise in a covered boat to an amazing part of this area. Cruise down the calm-water section of the Colorado River as you navigate down the river and offering views of 2,000 plus foot canyon walls towering above. Your cruise offers wonderful views of Moab arches, Indian petroglyphs and more.

ⓧ (B,D) Overnight: **Moab**

## DAY 3: CANYONLANDS NATIONAL PARK - DEAD HORSE POINT STATE PARK

Today visit Canyonlands National Park featuring deeply eroded canyons interspersed with sheer-sided mesas and a variety of spires, arches and unusual rock formations. A stop is made at Dead Horse Point State Park, towering high above the Colorado River offering breathtaking views of canyon country and the snaking Colorado River.

ⓧ (B) Overnight: **Moab**

## DAY 4: MOAB - MONUMENT VALLEY

This morning embark on a full day adventure to **Monument Valley**. Enter the Monument Valley Navajo Tribal

area offering vistas of stunning rock formations on your way to Monument Valley, the most filmed area in the west. Enjoy an included lunch at **Goulding's Lodge** and free time to visit **Goulding's Museum & Trading Post** to see a collection of Indian artifacts and a movie set from a John Wayne film. Later enjoy a **Monument Valley Scenic Drive Tour** with a knowledgeable Navajo guide aboard a four-wheel vehicle. Explore the areas oddly shaped monoliths, buttes and mesas of red sandstone. This area was the setting for some of John Ford's most memorable films. Return early this evening to Moab.

ⓧ (B,L) Overnight: **Moab**

## DAY 5: MOAB AS YOU WISH

The day is free for you to explore Moab and the area as you wish. An optional tour will be available today.

ⓧ (B) Overnight: **Moab**

## DAY 6: ARCHES NATIONAL PARK

This morning tour Arches National Park, one of our country's great national parks. Explore and see some of the famous arches, over 2,000 in total and marvel





Monument Valley



Hyatt Place Moab

## hts in Moab Utah

at other red rock formations and canyons. The afternoon is free to relax or explore Moab on your own. Later visit the **Red Cliffs Lodge** offering a ranch-like experience amid western charm and nestled high on the banks of the Colorado River and surrounded by magnificent 2,000-foot Red Rock Cliffs. Enjoy **Wine Tasting** at the Castle Creek Winery located on the property. Free time for a self-guided tour of the Movie History Museum housing historical movie-making memorabilia from early films to present. Later enjoy a **Farewell Dinner** at a popular local restaurant.

⊗ (B,D) Overnight: **Moab**

### DAY 7: MOAB - GRAND JUNCTION - FLIGHT HOME

Depart Moab and transfer to Grand Junction for your flight home filled with wonderful memories of your **Utah's Mighty National Parks Adventure**.

⊗ (B)



Arches National Park



### TRAVEL AND SAVE!

The Premier Compass Club rewards our valued guests with special recognition and a Compass Club Loyalty Credit on future tours and cruises.

Guests that have completed a trip will automatically be enrolled and will receive an additional \$100 per person or \$200 per couple Compass Club Loyalty Credit applied to their next Chamber Explorations tour or River Cruise. Loyalty Credit is valid for 24 months from your last tour.

For more details and information visit:  
**[premierworlddiscovery.com](http://premierworlddiscovery.com)**

## HIGHLIGHTS

- ▶ Grand Junction Colorado
- ▶ Scenic Byway 128
- ▶ Colorado National Monument
- ▶ Colorado River Cruise
- ▶ Canyonlands National Park
- ▶ Dead Horse Point State Park
- ▶ Monument Valley
- ▶ Lunch at Goulding's Lodge
- ▶ Goulding's Museum & Trading Post
- ▶ Arches National Park
- ▶ 5 Night Stay in Moab Utah

## INCLUSIONS

- ▶ Roundtrip Airfare - BOS
- ▶ Roundtrip Transfers- BOS
- ▶ 6 Nights First Class Hotels
- ▶ 10 Meals: 6 Breakfasts, 1 Lunch & 3 Dinners
- ▶ Professional Tour Director
- ▶ Motorcoach Transportation
- ▶ Admissions per Itinerary
- ▶ Comprehensive Sightseeing
- ▶ Baggage Handling at Hotels
- ▶ Hotel Transfers

## ACCOMMODATIONS

- ▶ 1 Night- DoubleTree Hotel, Grand Junction, CO
- ▶ 5 Nights- Hyatt Place Moab, Moab

On some dates alternative hotels may be used

### TOUR ACTIVITY LEVEL

Easy **1** **2** **3** **4** Active

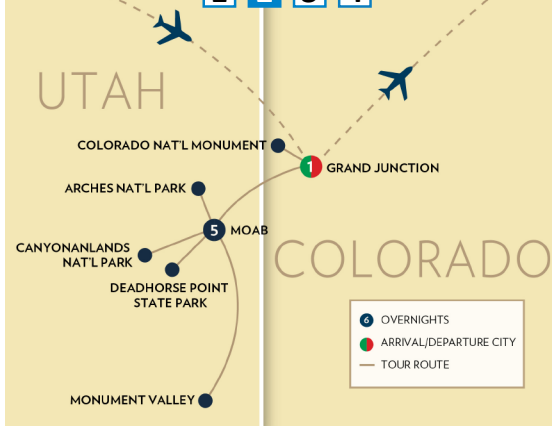

### TOUR RATES:

**Booking Discount\*: \$3049** pp double

**Regular Rate: \$3249** pp double

**Single Supplement: +\$995**

\*See Reservation Info for Booking Discount details

\*\* Chamber Member save an additional \$100 per person!



<b>RESERVATION FORM (USA)</b> UTAH'S MIGHTY NATIONAL PARKS June 16, 2022 Booking #155073 (Web Code)	<b>Contact Information/Mail Reservation Form to:</b> York Region Chamber • ATTN: Linda Chisholm 1 Stone Wall Lane York, ME 03909 207.363.4422 • linda@yorkme.org
--	--

Make checks payable to: **Chamber Explorations**

Enclosed please find a deposit in the amount of \$ \_\_\_\_\_ (\$300 per person) to secure reservations for \_\_\_\_\_ # of people.

Travel Protection Plan (TPP): ☐ Yes, I (we) wish to purchase travel protection (TPP)  
*(TPP must be purchased with initial deposit)* ☐ No, I (we) decline travel protection (TPP)

Enclosed please find payment in the amount of \$ \_\_\_\_\_ (\$285 per person) to secure the Premier's Travel Protection Plan (TPP).

**TOTAL PAYMENT \$** \_\_\_\_\_

I (we) are members of the **York Region Chamber of Commerce**: Yes \_\_\_\_\_ No \_\_\_\_\_

**RT AIR GATEWAY** \_\_\_\_\_ **ROOMMATE'S RT AIR GATEWAY** \_\_\_\_\_

*see flyer page 3 for included group RT gateway/departure city, additional charges apply for other RT air packages*

To avoid change fees, submit full legal names (first/mid/last) exactly as they appear on the government issued ID used for travel (**REAL ID/Passport**)

**Legal Name:** \_\_\_\_\_

DOB (MM/DD/YY) \_\_\_\_\_ Gender ☐ M ☐ F

**Roommate's Legal Name:** \_\_\_\_\_

DOB (MM/DD/YY) \_\_\_\_\_ Gender ☐ M ☐ F

Street Address \_\_\_\_\_ ☐ Check if Roommate's address is the same

City \_\_\_\_\_ State \_\_\_\_\_ ZIP \_\_\_\_\_

Email address \_\_\_\_\_

Mbl# \_\_\_\_\_

Emergency Contact/Tel# \_\_\_\_\_

Notes: \_\_\_\_\_

☐
☐
☐
☐

Cardholder Name (If paying by credit card) \_\_\_\_\_

Credit Card # \_\_\_\_\_ Exp Date: \_\_\_\_\_

CVV# \_\_\_\_\_ **Amount to be charged \$** \_\_\_\_\_

Credit Card Billing Address: ☐ Check if address is the same as above

Address \_\_\_\_\_ City \_\_\_\_\_

State \_\_\_\_\_ ZIP \_\_\_\_\_ Tel# \_\_\_\_\_

Sign \_\_\_\_\_ Date \_\_\_\_\_

**SIGNATURE REQUIRED** (for credit card use & acceptance of terms\*)  
*\*I (We) agree to pay according to the credit card issuer agreement. I understand and accept the cancellation fees/policy and other terms.*

**DEPOSIT & FINAL PAYMENT**  
 Deposit of \$300 per person is due with Reservation Form to secure reservations. Final Payment Due Date is 75 days prior to departure.

**\*BOOKING DISCOUNT**  
 Make your Final Payment by check prior to the Final Payment Due Date & receive **\$400 per couple/\$200 per person Booking Discount!**  
 •Initial Deposit can be made by check or credit card to be eligible.  
 •Payments after Initial Deposit are considered part of Final Payment & must be made by check.

**ONLINE BOOKING OPTION**  
 Save time, postage & secure your seat for this group departure. Simply type <https://res.chamberexplorations.com> into your web browser & use the Booking Number (Web Code) from this flyer to make your Deposit online in just a few minutes. No need to submit a Reservation Form if booking online.

**TRAVEL PROTECTION PLAN (TPP) \$285 per person**  
 (must purchase with Initial Deposit)

**Part A – Cancellation Waiver provided by PWD**  
 I. Trip Cancellation Waiver (TCW) - Guarantees full refund on all payments, except the Trip Cancellation Waiver Fee itself in case of cancellation up to the time and date of departure due to the passenger's personal illness or death of an immediate family member. Medical/official documentation required.

II. Premier "Any Reason" Cancellation Waiver (ARCW) - Reimburses 75% of the cancellation fees in the form of a future travel credit certificate (FTCC) valid for 1 year, if you cancel more than 48 hours prior to scheduled departure for any reason not eligible for cash refund under the TCW (Part A – I.). FTCC is non-transferable, may not be redeemed for cash and does not include any credit for the Trip Cancellation Waiver Fee. **The Trip Cancellation Waiver Fee must be paid for with Initial Deposit and is refundable until 180 days prior to departure.** The Trip Cancellation Waiver does not cover any single supplement charges due to an individual's traveling companion canceling prior to departure. The Trip Cancellation Waiver is non-transferable and valid for each applicant only. The Trip Cancellation Waiver does not cover any services such as airline tickets not purchased through PWD. Cancellations, Refunds & Inquiries under Part A will be handled by PWD. Certain Exclusions and Restrictions apply.

**Part B – Post Departure Travel Protection Plan\* provided by USI**  
 Includes coverage for: Trip Interruption (\$1,000); Trip Delay (\$100/Day-Max \$500); Baggage & Personal Effects (\$2,000); Baggage Delay (\$500); Emergency Accident/Sickness Medical Expense - excess coverage (\$30,000); Emergency Evacuation/Repatriation (\$150,000); Accidental Death & Dismemberment (\$25,000); Non-Insurance and Emergency Travel Assistance Services\*\* (24/7). Claims & Inquiries under Part B will be administered by USI.

For full Part A and Part B plan details visit: [chamberexplorations.com/TPP](http://chamberexplorations.com/TPP)  
 All Benefits described on this page are for general information basis only. There are certain restrictions, exclusions and limitation that apply to all insurance coverages. Plan benefits, limits and provisions may vary by state jurisdiction.

**\*\*NO RISK DEPOSIT - NO CHANGE FEES**  
 Deposits & TPP payments for any Bookings made for this tour between Jan 1, 2021-Dec 31, 2022 are fully refundable until 180 days prior to departure, should your plans change inside of 180 days you can use the full value (Future Travel Credit\*\*) of your Deposit or TPP on a different program as long as you change plans or let us know prior to the Final Payment Due Date.

**CANCELLATION FEES\*\***  
 Cancellations not covered by the Travel Protection Plan (TPP) or if the TPP is not purchased, are subject to the following per person fees:

- Cancel more than 180 days prior to departure:	Full Refund
- Cancel 179-75 days prior to departure:	Deposit or TPP* is Retained**
- Cancel 74-60 days prior to departure:	25% of total price
- Cancel 59-30 days prior to departure:	50% of total price
- Cancel 29-15 days prior to departure:	75% of total price
- Cancel 14 days or less prior to departure/no shows:	No refunds

\*If purchased \*\*Future Travel Credit issued for Deposit or TPP\* value

**RESPONSIBILITY**  
 Premier World Tours LLC dba Chamber Explorations (hereafter PWD/VR), whose vouchers are used by respective agents for the passenger in all matters pertaining to hotel accommodations, sightseeing tours and transportation, hold themselves free of responsibility for any damages occasioned from any cause whatsoever. PWD/CE will not be responsible for any damages or inconvenience caused by late arrivals, departures and change of schedule or other conditions nor will they be responsible for any act, omission, or event during the time the passenger is not on board their conveyance. The passage contract in use by the airline concerned, when issued, shall constitute the sole contract between the airline and the purchaser of this tour/cruise, and/or passenger. PWD/CE does not hold any responsibility for the conduct of any of its members, hotel, motorcoach, cruiseline, train, airline or other personnel. PWD/CE reserves the right to decline to accept or retain any person as a member of a tour/cruise at its discretion. PWD/CE &/or its Tour Director retain the right to require any participant to withdraw from a tour/cruise at any time, if determined to be in the best interests of health, safety & general welfare of the tour/cruise group or of the individual participant. Arbitration- I/We agree, any and all disputes concerning this contract or any other material concerning the trip, or the trip itself must be resolved exclusively pursuant to binding arbitration in the state of California, pursuant to the then current rules of the American Arbitration Association. Payment of the deposit for this tour/cruise constitutes acceptance of these terms and conditions. CST #2048841-40

**IMPORTANT CONDITIONS/NOTES**  
 Itinerary and hotels are subject to change.

**AIR NOTE**  
 Air Schedules may not be available until Final Trip Documentation is received. Air seats are assigned by the airline and sometimes not assigned until the day of travel. Air seat changes can only be attempted upon receipt of e-tickets and Final Trip Documentation at which time availability may be limited. If specific seat assignments or airline choice is extremely important to your reservation, we recommend you book land only and make your own air reservations. Please make this adjustment to land only/own air at time of tour reservation.

Exclusive Charter



York Regional Chamber presents



# Wonders of the Danube River Cruise

featuring Budapest, Vienna & 7 Nights aboard the Amadeus Star

9 Days October 29, 2022



**BOOKING  
DISCOUNT!**

Save \$200 per person  
\$400 per couple\*

\*See Reservation Info for  
Booking Discount details





9 Days **October 29, 2022**

## Wonders of the Danube River Cruise

### Day 1 - DEPART US - OVERNIGHT FLIGHT

### Day 2 - ARRIVE BUDAPEST - BOARD SHIP

Meet Tour/Cruise Manager - Transfer & board **MS Amadeus Star** for 7 nights

**Welcome Dinner Onboard** - Ship docked overnight in Budapest



(D)

*Overnight - Amadeus Star*

### Day 3 - BUDAPEST - ESZTERGOM

Morning **Budapest City Tour** - Ship departs Budapest after lunch

Afternoon cruising or *Optional Esztergom, Visegrad Castle & Szentendre*



(B,D)

*Overnight - Amadeus Star*

### Day 4 - BRATISLAVA

Morning **Bratislava City Tour** - Ship docked in Bratislava late into the evening

Afternoon at Leisure or *Optional Schloss Hof Palace & Estate*



(B,L,S & D)

*Overnight - Amadeus Star*

### Day 5 - VIENNA

Morning **Vienna City Tour** - Ship docked in Vienna late into the evening

Afternoon at Leisure or *Optional to Schoenbrunn Palace*



(B,L,S & D)

*Overnight - Amadeus Star*

### Day 6 - DURNSTEIN - MELK/EMMERSDORF

Morning **Durnstein Walking Tour & Abbey**

Afternoon cruising or *Optional Wachau Valley Winery & Tasting*



(B,L,S & D)

*Overnight - Amadeus Star*

### Day 7 - LINZ - PASSAU - SALZBURG OPTIONAL

Morning Linz stop - Danube Cruising- Relax onboard or *Optional Full-day excursion to Salzburg including Salzkammergut and Lunch* - **Gala Farewell Dinner Onboard**



(B,L,S & D)

*Overnight - Amadeus Star*

### Day 8 - REGENSBURG

Morning **Regensburg Walking Tour** - Ship docked in Regensburg into the evening

Afternoon at Leisure or *Optional Danube Gorge, Weltenburg Abbey & Beer Tasting*

**Bavarian Dinner Onboard**



(B,L,S & D)

*Overnight - Amadeus Star*

### Day 9 - PASSAU - MUNICH - FLIGHT HOME OR PRAGUE 2 NIGHT EXTENSION

Disembark Passau - Transfer to Munich Airport - Fly Home or *2 Night Prague Ext.*



(B)

B-Breakfast Hotel/Onboard • S-Snacks Onboard afternoon and/or evening

L-Lunch Onboard • D-Dinner Onboard with Beer & Regional Wines

## CITIES & PORTS

### BUDAPEST, HUNGARY

Budapest is one of Europe's most beautiful cities. The city straddles both banks of the Danube linked by seven bridges including the famous Chain and Elizabeth Bridges. An included sightseeing tour presents you with a fantastic opportunity to become acquainted with Hungary's beautiful capital. Enjoy a photo stop at Gellert Hill, see historic Buda Castle, 500-year-old Matthias Church, St. Stephen's Basilica, the distinctive Fisherman's Bastion and the marvelous Royal Palace.

### BRATISLAVA, SLOVAKIA

Awake today in the capital city of Bratislava in Slovakia. Enjoy a Bratislava City Tour and walk through the city, see the home of the Slovak Philharmonic Orchestra, the old city walls, the summer residence of the archbishop and the current residence of the president of Slovakia. Traverse through the restored old town, from Michael's Gate, and admire other impressive sights such as the Primatial Palace and St. Martin's Cathedral, former coronation cathedral for Hungarian kings. Bratislava is a little jewel along the Danube.

### VIENNA, AUSTRIA

Enjoy an included Vienna City Tour. For over 600 years, the magnificent baroque capital city of Vienna was the seat of the mighty Hapsburg Emperors, a heritage that has bestowed it with many dazzling palaces and monuments: the lavish Hofburg Palace, the impressive Vienna Opera House and the majestic Ringstrasse. The capital is also known as the "City of Music" for having once been the home of composers such as Beethoven, Schubert, Mozart and Johann Strauss. Maybe visit the Schoenbrunn Palace.

### DURNSTEIN, AUSTRIA

The romantic Wachau Valley is one of the most beautiful regions of Austria. Visit Durnstein, a town well-known for its first-class wines and Abbey, which you visit during the morning sightseeing walk. This afternoon maybe enjoy a wine experience with an optional to the Wachau Valley for a Winery visit & Tasting.

### REGENSBURG, GERMANY

Situated in Eastern Bavaria, Regensburg is one of Germany's oldest towns, founded by the Romans in 179 A.D. Today it is a prosperous city with 3 universities and many landmarks dated to the Middle Ages. Enjoy a Regensburg Walking Tour through one of the most visited cities in Germany and its Medieval Old Town, a UNESCO World Heritage site. This afternoon an excursion will be available to the Weltenburg Abbey.

### SALZBURG, AUSTRIA - OPTIONAL FULL DAY EXCURSION

Travel to Salzburg for a walking tour of the famous Old Town, Mirabel Gardens, Mozart Square, the Dom Cathedral and historic center made famous by the "Sound of Music." Wander by Mozart's Birthplace located at No. 9 Getreidegasse, the home where the Mozart family lived from 1747-1773. After an included lunch, head to the picturesque village of Mondsee, another film location of "The Sound of Music". Enjoy the beautiful scenery as you return to the ship.

### Optional 2 Night Prague Post Cruise Extension

\$695 pp dbl +\$250 single supplement

#### Day 9 Passau - Prague, Czech Republic

Board Motorcoach - Travel & Arrive Prague for 2 nights at a hotel

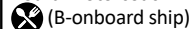

(B-onboard ship)

*Overnight - Prague*

#### Day 10 Prague

**Prague City Tour** - Prague Castle, Charles Bridge & St. Vitus Cathedral

Afternoon at Leisure - **Prague Dinner & Folklore Show**

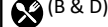

(B & D)

*Overnight - Prague*

#### Day 11 Prague - Flight Home

Transfer to Prague Airport - Flight Home



(B)

**Prague Extension Includes:** Transportation to Prague, 2 Nights Hotel - Prague, Tour Manager, 3 Meals: 2-B & 1-D, Prague City Tour & Transfer to Prague Airport

**Notes:** Prague Extension must be booked at time of deposit. Due to group air policies outbound air on 10/29/2022 could be a different schedule than the rest of your group for Prague extension passengers. • Prague Ext is based on 20 passenger minimum





MS Amadeus Star



Fine Dining



Fitness Center

## AMADEUS STAR

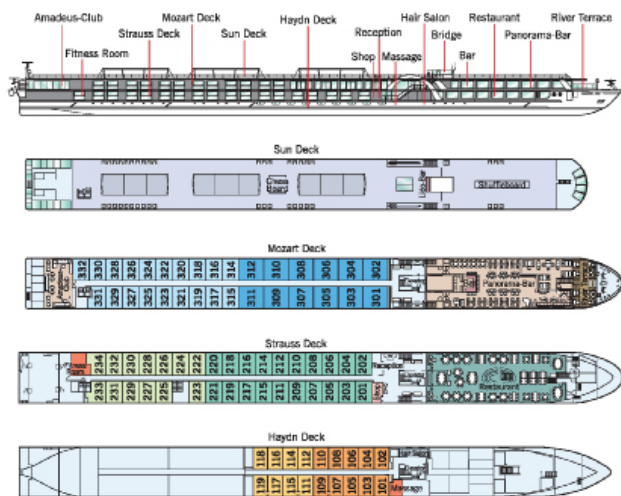

### THE SHIP - MS AMADEUS STAR

The innovative 164 passenger *Amadeus Star*, launched in 2019, offers all the amenities of a floating 5-star hotel. This Premium cruise ship features the most modern furnishings that blend masterfully with the architecture of the ship and a luxurious design that is the hallmark of the Amadeus fleet. The extensive Restaurant and the Panorama Bar offer divine views of the passing riverscapes, and the glass-shielded River Terrace allows you to relax in the open air. The attentive English-speaking onboard service staff will see to your comfort with typical European hospitality. The cabin design plans are forward-thinking, bright & modern, all part of a premium focus with 70 large Staterooms & 12 Suites. The beauty of river cruising is that the most interesting destinations come to you. This Star charter features English-only onboard commentary with inclusive shore excursions balanced with choice to simply relax onboard, get a spa treatment or add sightseeing with optional excursions.

### ALL MEALS INCLUDED ONBOARD

Three meals daily are served graciously in the exquisite restaurant and feature local & international specialties. All dinners are four courses and are served with included regional wines & beer. While dining, you have splendid views of the passing scenic landscapes through the large picture windows. Enjoy afternoon and/or late evening snacks in the lounge based on the daily schedule.

### COMFORTABLE & INNOVATIVE STATEROOMS

After boarding, unpack once. All staterooms are larger than traditional river cruise cabins & offer excellent river views. The Mozart Deck features 12 Suites with Walk Out Balconies. The other 19 Staterooms on the Mozart Deck & 33 Staterooms on the Strauss Deck feature an innovative Drop-Down Panoramic Window. The 18 Staterooms on the Haydn Deck have a fixed window. All staterooms are fully equipped with comfortable & modern furnishings including flat screen TV & large private bathrooms with shower.

#### SHIP TECHNICAL DATA

Launched:	2019	Max passengers:	164
Decks:	4	Crew members:	40
Length/ Width (ft):	443/37.5	Cabins/Suites:	70/12

## INCLUSIONS

- Roundtrip Airfare- BOS
- Roundtrip Transfers- BOS
- 7 Night Cruise - Outside Cabin
- 20 Meals (7-B, 6-L & 7-D)
- CE Tour/Cruise Manager
- Regional Wine & Beer with Dinners
- Ship Staff
- Baggage Handling at Hotel & Ship
- Int'l Air Taxes/Fuel/Port Charges
- Wifi Onboard
- Hotel & Ship Transfers

## EXCURSIONS/TOURS

- Budapest City Tour
- Bratislava City Tour
- Vienna City Tour
- Dürnstein Walking Tour & Abbey
- Regensburg Walking Tour
- Extended Port Time in Budapest, Vienna, Bratislava & Regensburg
- Welcome & Farewell Dinners
- Bavarian Dinner Onboard

## RATES

Cat E - Haydn Deck	\$4095 pp dbl*	<b>\$3895 pp dbl with BD**</b>	+\$950 single
Cat D - Haydn Deck	\$4295 pp dbl*	<b>\$4095 pp dbl with BD**</b>	+\$950 single
Cat C - Strauss Deck	\$4695 pp dbl*	<b>\$4495 pp dbl with BD**</b>	+\$1500 single
Cat B - Strauss Deck	\$4895 pp dbl*	<b>\$4695 pp dbl with BD**</b>	+\$1500 single
Cat A - Mozart Deck	\$5095 pp dbl*	<b>\$4895 pp dbl with BD**</b>	+\$1900 single
Suite - Mozart Deck	\$5495 pp dbl*	<b>\$5295 pp dbl with BD**</b>	+\$2300 single

**Booking Discount - \$400 per couple/\$200 pp**

\*\*Chamber Member save an additional \$100 per person

## STATEROOMS & SUITES



### STATEROOMS - 172 or 188 SQ FT

All staterooms feature 2 twin beds that can be separated or put together, flat screen TV, private bath with shower, hair dryer, closet, phone, desk, chair & safe. Mozart & Strauss Staterooms feature Drop Down Panoramic Window with 188 sq. ft. of floor space. Haydn Deck Staterooms feature a fixed window with 172 sq ft. (stateroom size & amenities can vary)

Stateroom Haydn Deck (172 sf)

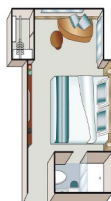

Stateroom Strauss & Mozart Decks (188 sf)

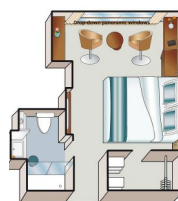

### SUITE - 284 SQ FT WITH BALCONY

All suites are on the Mozart Deck and have panoramic windows with exterior Walk Out Balcony, two twin beds that can be separated or put together, a private sitting area, flat screen TV, mini-bar, private bath with shower, hair dryer, phone, closet, desk, chair, safe & offer 284 square feet of floor space. (Suite size and amenities can vary)

Suite Mozart Deck (284 sf)



**Reservation Form (River Cruise)**

Wonders of the Danube River Cruise  
October 29, 2022  
Booking #155074 (Web Code)

**Contact Information/Mail Reservation Form to:**

York Region Chamber • ATTN: Linda Chisholm  
1 Stone Wall Lane  
York, ME 03909  
207.363.4422 • linda@yorkme.org

**Cabin Category Requested:** *(All Cabin Categories are on a space available basis)*

Cat E: ☐ Cat D: ☐ Cat C: ☐ Cat B: ☐ Cat A: ☐ Suite: ☐

Enclosed please find a deposit in the amount of \$ \_\_\_\_\_ (\$500 per person)  
to secure reservations for \_\_\_\_\_ # of people.

Travel Protection Plan (TPP) ☐ Yes, I (we) wish to purchase travel protection (TPP)  
☐ No, I (we) decline travel protection (TPP)

Enclosed please find payment in the amount of \$ \_\_\_\_\_ (\$440 per person)  
to secure the Premier's Travel Protection Plan (TPP). *(TPP must be purchased with initial deposit)*

I / we want to purchase the Prague Post Extension\*\*\* (\$695 pp dbl/+\$250 SS) ☐ Yes ☐ No

\*\*\*Please book Prague Ext with initial deposit.

**TOTAL PAYMENT \$ \_\_\_\_\_** Make checks payable to: **CHAMBER EXPLORATIONS**

I (we) are members of the **York Region Chamber of Commerce**: Yes ☐ No ☐

**RT AIR GATEWAY \_\_\_\_\_ ROOMMATE'S RT AIR GATEWAY \_\_\_\_\_**

*see flyer page 3 for included group RT gateway/departure city, additional charges apply for other RT air packages*

To avoid change fees, submit Passport names (first/mid/last) exactly as they appear on Passports

**Passport Name:** \_\_\_\_\_

DOB (MM/DD/YY) \_\_\_\_\_ Gender ☐ M ☐ F

Passport #: \_\_\_\_\_ Exp Date (MM/DD/YY) \_\_\_\_\_

Country of Issuance \_\_\_\_\_

**Roommate's Passport Name:** \_\_\_\_\_

DOB (MM/DD/YY) \_\_\_\_\_ Gender ☐ M ☐ F

Roommate's Passport #: \_\_\_\_\_ Exp Date (MM/DD/YY) \_\_\_\_\_

Country of Issuance \_\_\_\_\_

Street Address \_\_\_\_\_ ☐ Check if Roommate's address is the same

City \_\_\_\_\_ State \_\_\_\_\_ ZIP \_\_\_\_\_

Email address \_\_\_\_\_ Mbl# \_\_\_\_\_

Emergency Contact/Tel# \_\_\_\_\_

Notes: \_\_\_\_\_



Cardholder Name (If paying by credit card) \_\_\_\_\_

Credit Card # \_\_\_\_\_ Exp Date: \_\_\_\_\_

CVV# \_\_\_\_\_ Amount to be charged \$ \_\_\_\_\_

Credit Card Billing Address: ☐ Check if address is the same as above

Address \_\_\_\_\_ City \_\_\_\_\_

State \_\_\_\_\_ ZIP \_\_\_\_\_ Tel# \_\_\_\_\_

Sign \_\_\_\_\_ Date \_\_\_\_\_

**SIGNATURE REQUIRED** (for credit card use & acceptance of terms\*)

*\*I (We) agree to pay according to the credit card issuer agreement. I understand and accept the cancellation fees/policy and other terms.*

**DEPOSIT & FINAL PAYMENT**

An Initial Deposit of \$500 per person is due with Reservation Form to secure reservations. Final Payment Due Date is 90 days prior to departure.

**\*BOOKING DISCOUNT**

Make your Final Payment by check prior to the Final Payment Due Date

& receive **\$400 per couple/\$200 per person Booking Discount!**

• Initial Deposit can be made by check or credit card to be eligible.

• Payments after Initial Deposit are part of Final Payment & must be made by check.

**ONLINE BOOKING OPTION**

Save time, postage & secure your seat for this group departure. Simply type: <https://res.chamberexplorations.com> into your web browser & use the Booking Number (Web Code) from this flyer to make your Deposit online in just a few minutes. No need to submit a Reservation Form if booking online.

**PREMIER'S TRAVEL PROTECTION PLAN (TPP) \$440 per person**  
(must purchase with Initial Deposit)

**Part A – Cancellation Waiver provided by PWD/CE**

**I. Trip Cancellation Waiver (TCW)** - Guarantees full refund on all payments, except the Trip Cancellation Waiver Fee itself in case of cancellation up to the time and date of departure due to the passenger's personal illness or death of an immediate family member. Medical/official documentation required.

**II. Premier "Any Reason" Cancellation Waiver (ARCW)** - Reimburses 75% of the cancellation fees in the form of a future travel credit certificate (FTCC) valid for 1 year, if you cancel more than 48 hours prior to scheduled departure for any reason not eligible for cash refund under the TCW (Part A – I.). FTCC is non-transferable, may not be redeemed for cash and does not include any credit for the Trip Cancellation Waiver Fee. **The Trip Cancellation Waiver Fee must be paid for with Initial Deposit and is refundable until 180 days prior to departure. The Trip Cancellation Waiver does not cover any single supplement charges due to an individual's traveling companion canceling prior to departure.** The Trip Cancellation Waiver is non-transferable and valid for each applicant only. The Trip Cancellation Waiver does not cover any services such as airline tickets not purchased through PWD/CE. Cancellations, Refunds & Inquiries under Part A will be handled by PWD/CE. Certain Exclusions and Restrictions apply.

**Part B – Post Departure Travel Protection Plan\* provided by USI**

Includes coverage for: Trip Interruption (\$1,000); Trip Delay (\$100/Day-Max \$500); Baggage & Personal Effects (\$2,000); Baggage Delay (\$500); Emergency Accident/Sickness Medical Expense- excess coverage (\$30,000); Emergency Evacuation/Repatriation (\$150,000); Accidental Death & Dismemberment (\$25,000); Non-Insurance and Emergency Travel Assistance Services\*\* (24/7). Claims & Inquiries under Part B will be administered by USI.

**For full Part A and Part B plan details visit: [premierworlddiscovery.com/TPP](http://premierworlddiscovery.com/TPP)**  
All Benefits described on this page are for general information basis only. There are certain restrictions, exclusions and limitation that apply to all insurance coverages. Plan benefits, limits and provisions may vary by state jurisdiction.

**CANCELLATION FEES**

Cancellations are subject to the following per person fees;

- Cancel 180 days prior to departure:	\$200 pp is retained
- Cancel 179-90 days prior to departure:	Deposit or TPP** is retained
- Cancel 89-60 days prior to departure:	50% of total price
- Cancel 59-30 days prior to departure:	75% of total price
- Cancel 29 days or less prior to departure/no shows:	No refunds

\*\*If TPP purchased

**RESPONSIBILITY**

Premier World Tours LLC dba CHAMBER EXPLORATIONS (hereafter PWD/CE), whose vouchers are used by respective agents for the passenger in all matters pertaining to hotel accommodations, sightseeing tours and transportation, hold themselves free of responsibility for any damages occasioned from any cause whatsoever. PWD/CE will not be responsible for any damages or inconvenience caused by late arrivals, departures and change of schedule or other conditions nor will they be responsible for any act, omission, or event during the time the passenger is not on board their conveyance. The passage contract in use by the airline concerned, when issued, shall constitute the sole contract between the airline and the purchaser of this tour/cruise, and/or passenger. PWD/CE does not hold any responsibility for the conduct of any of its members, hotel, motorcoach, cruiseline, train, airline or other personnel. PWD/CE reserves the right to decline to accept or retain any person as a member of a tour/cruise at its discretion. PWD/CE &/or its Tour Director retain the right to require any participant to withdraw from a tour/cruise at any time, if determined to be in the best interests of health, safety & general welfare of the tour/cruise group or of the individual participant. Arbitration- I/We agree, any and all disputes concerning this contract or any other material concerning the trip, or the trip itself must be resolved exclusively pursuant to binding arbitration in the state of California, pursuant to the then current rules of the American Arbitration Association. Payment of the deposit for this tour/cruise constitutes acceptance of these terms and conditions. CST #2048841-40

**IMPORTANT CONDITIONS/NOTES**

• A valid US passport is required for this tour and is the responsibility of each passenger. Passports should be valid for up to six (6) months beyond the travel dates. All names must be submitted to Premier exactly as they appear on passenger passports.

• Itinerary and hotels are subject to change.

**AIR NOTE**

Air Schedules may not be available until Final Trip Documentation is received. Air seats are assigned by the airline and sometimes not assigned until the day of travel. Air seat changes can only be attempted upon receipt of e-tickets and Final Trip Documentation at which time availability may be limited. If specific seat assignments or airline choice is extremely important to your reservation, we recommend you book land only and make your own air reservations. Please make this adjustment to land only/own air at time of tour reservation.







**YORK  
REGION**

Kittery  
Eliot  
York  
South Berwick  
Cape Neddick

Chamber of Commerce

# Highlights of Italy's Amalfi Coast

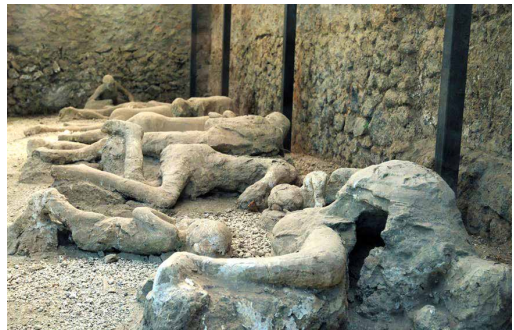

**BOOKING  
DISCOUNT!**

Save \$200 Per Person  
\$400 Per Couple\*

**November 8, 2022**

**8 DAYS**

**NO RISK DEPOSIT  
NO CHANGE FEES**

Book Now and your Deposit is Risk Free with  
No Change Fees until Final Payment Due Date!  
See back for details\*\*



**TOUR RATES:**

Booking Discount\*: **\$3249** pp double

Regular Rate: **\$3449** pp double

Single Supplement: +\$475

\*See Reservation Info for Booking Discount details

\*\* Chamber Member save an additional \$100 per person!



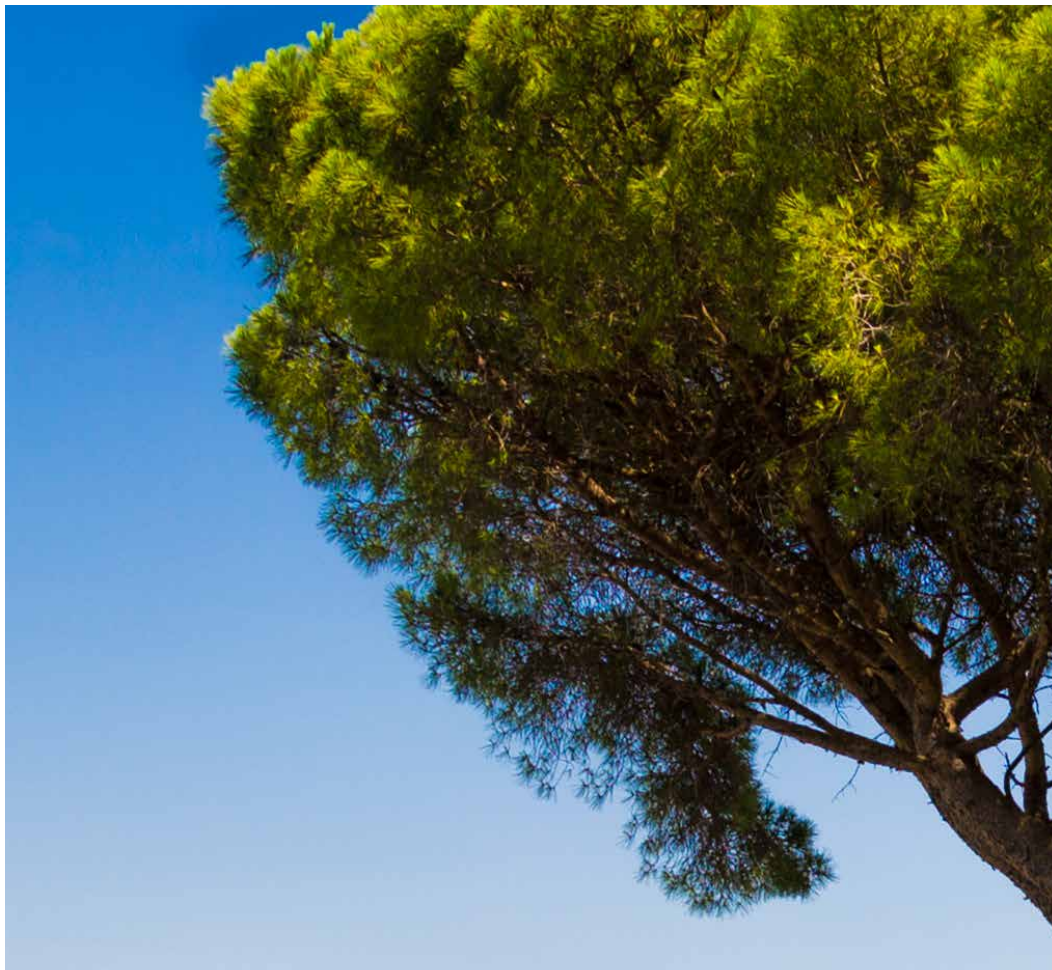

# Highlights of Italy's Amalfi Coast

## DAY 1: DEPART USA

Board your overnight flight to Italy.

## DAY 2: ARRIVAL IN ROME ITALY – SORRENTO COAST

Welcome to Italy! After clearing customs, meet your Tour Director who will assist with your transfer to the **Amalfi Coast**. A **Welcome Dinner** is included this evening.

☒ (D) Overnight: **Sorrento Coast**

## DAY 3: SORRENTO COAST – RAVELLO

Start the day with a **Sorrento Walking Tour**, a coastal town facing the Bay of Naples on the Sorrentine Peninsula perched atop cliffs that separate the town from its marinas. Sorrento is known for sweeping water views and Piazza Tasso, a cafe-lined square filled with artisan shops selling local wares. The historic center is home to the **Chiesa di San Francesco**, a 14th-century church and is the birthplace of the Limoncello liqueur. Next enjoy a **Limoncello Demonstration** on how it's made followed by a tasting, it goes down easily, Salute! Later, visit **Ravello**, a hillside town offering spectacular coastal views and grand villas with perfectly laid out flower beds, palm trees, sculptures and fountains. Ravello is famous for its Villa Rufolo built in 1200 AD. Free time to explore, shop and enjoy lunch on your own. Return to the hotel with the evening at leisure.

☒ (B,D) Overnight: **Sorrento Coast**

## DAY 4: SORRENTO COAST - POSITANO - AMALFI (UNESCO)

After breakfast meet your Tour Director for a full day excursion of the **Amalfi Coast**. The Amalfi Coast claims to be Europe's most magnificent stretch of coastline and extends from Positano in the West to Vietre sul Mare in the East. Today we see why with its breathtaking scenery, glamorous resorts hidden away on the spectacular cornice that winds its way past citrus plantations, vineyards and tiny villages clinging on to jagged cliffs that plunge straight into the sea. Continue to **Amalfi**, named a UNESCO World Heritage Site. The first view of Amalfi is unforgettable, with its tightly packed villas and palaces seeming to tumble down the cliff side into the fishing port and beach below. Amalfi was once a maritime power to rival Venice, and its golden age is symbolized by its stunning cathedral and the **Piazza Duomo**. We'll also visit picturesque **Positano**, a town full of fashionistas, celebrities, wealthy jet setters and upscale shops. Next visit a **Cheese Factory** for an opportunity to taste the freshly made mozzarella cheese.

☒ (B,D) Overnight: **Sorrento Coast**

## DAY 5: SORRENTO COAST

Enjoy a day at leisure or join the full day optional excursion to the Isle of Capri. Capri is an enchanting and picturesque island, a favorite with Roman emperors, the rich and famous, artists, and writers; it's still one of the Mediterranean's must-see places. Transfer to the harbor to board a jetfoil boat for your journey across the Bay of Naples to the Isle of Capri. Upon arrival to the port of Capri you'll transfer to **Ana Capri** with free time to explore on your own or visit Villa San Michele, the home of Swedish doctor and writer Axel Munthe. Later we return to Capri with free time to explore and have lunch on your own. Return to the hotel later today.

☒ (B) Overnight: **Sorrento Coast**

## DAY 6: SORRENTO COAST

Enjoy a full day to explore on your own today or join the optional guided tour to Naples. Here we will enjoy a panoramic Naples City Tour seeing the Cathedral with its treasure chapel and basilica, dating back to the 4th century. You'll also drive to Plebiscite Square to see the Royal Palace, the beautiful church of St. Francesco di Paula, the Town Hall Square and the New Castle built by the French Family of Anjou. Enjoy an included lunch at a local Naples pizzeria. The afternoon is free to shop and explore Naples on your own before returning back to the hotel.

☒ (B) Overnight: **Sorrento Coast**





### DAY 7: SORRENTO COAST - POMPEII - ROME

This morning after breakfast depart the Sorrento area for **Pompeii**, one of Italy's most unique and famous archaeological sights. Enjoy a fascinating guided visit to this site. Imagine, a city perfectly preserved as it was on that fateful day 2,000 years ago, when Mt. Vesuvius erupted covering the city in deadly volcanic ash and lava, literally stopping time in its tracks. You'll see the tragic fossils of people attempting to escape and the haunting ruins. Continue onto the "Eternal City" of **Rome**, the capital and largest city in Italy. The center of power, culture and religion, Rome has exerted influence over the world in its 2800 years of existence. Check into your hotel. Enjoy a **Farewell Dinner** tonight with new found friends including wine.

✕ (B,D) Overnight: **Rome**

### DAY 8: ROME - BUON VIAGGIO – FLIGHT HOME – USA

Transfer to the airport for your journey home with wonderful memories of your Highlights of the Amalfi Coast tour. Those adding the optional two-night Rome extension will continue sightseeing in Rome today.

✕ (B)

### TOUR ACTIVITY LEVEL

Easy **1** **2** **3** **4** Active

### \*\*OPTIONAL 3 DAY / 2 NIGHT ROME EXTENSION

#### DAY 8: ROME - VATICAN MUSEUM

Enjoy a **Rome City Tour** to see some of the highlights of the city such as, the Colosseum, The Arch of Constantine, Circus Maximus, Piazza Venezia, the Pantheon and more. Next it's off to visit another country – Vatican City. With our expert local guide we'll tour the **Vatican Museums**- a massive collection of ancient Greek sculptures, medieval tapestries and Renaissance paintings. Our visit ends in the **Sistine Chapel**, it's ceiling painted by Michelangelo between 1508 and 1512. This room, receives more than five million visitors each year and is also where the Pope is elected. Next visit **St. Peter's Basilica**, by far one of the worlds largest churches. We'll see Michelangelo's **Pieta**, sculpted when he was just 24 years old, as well as Bernini's seven story bronze canopy located above the main altar and more. Enjoy the evening at leisure in Rome. ✕ (B) Overnight: **Rome**

#### DAY 9: ROME AT LEISURE

The entire day is free to explore the 'Eternal City' on your own. Perhaps a tour inside the Colosseum, a walk on Via Veneto, indulge in an espresso or cappuccino in the Piazza Navona, climb up the Spanish Steps, sample some gelato at a local café or shop for souvenirs to bring home.

✕ (B) Overnight: **Rome**

#### DAY 10: ROME – FLIGHT HOME

Journey home with wonderful memories of Rome. ✕ (B)

### \*\*RATES: \$595 PP DBL / +\$200 SINGLE SUPPLEMENT

**INCLUSIONS:** Two Nights Rome, 2 Breakfasts, Tour Director, Deluxe Motorcoach, Rome City Tour, Entrance into Vatican Museum/Sistine Chapel, Admissions per Itinerary, Baggage Handling & Airport Transfers.

*\*\*Extension must be booked with your initial \$500 tour deposit. Due to group air policies outbound air could be a different schedule than the rest of your group for Rome extension passengers. • 20 passenger minimum*

### TOUR HIGHLIGHTS

- ▶ 5 Nights One Hotel
- ▶ 1 Night Rome
- ▶ The Amalfi Coast
- ▶ Pompeii
- ▶ Sorrento
- ▶ Ravello
- ▶ Amalfi
- ▶ Positano
- ▶ Limoncello Demonstration
- ▶ Cheese Factory Visit
- ▶ Two Optional Excursions Isle of Capri & Naples
- ▶ Isle of Capri

### INCLUSIONS

- ▶ Roundtrip Airfare - BOS
- ▶ Roundtrip Transfers- BOS
- ▶ Int'l Air Dep. Taxes/Fuel
- ▶ 10 Meals: 6 Breakfast & 4 Dinners
- ▶ Professional Tour Director
- ▶ 6 Nights First Class Hotels
- ▶ Motorcoach Transportation
- ▶ Admissions & Sightseeing per Itinerary
- ▶ Hotel Transfers
- ▶ Baggage Handling at Hotels

### ACCOMMODATIONS

- ▶ 5 Nights - Hotel Mary, Vico Equense - Sorrento area
  - ▶ 1 Night - Smooth Hotel Rome West, Rome
- On some dates alternative hotels may be used



### TOUR RATES:

Booking Discount\*: **\$3249** pp double

Regular Rate: **\$3449** pp double

Single Supplement: **+\$475**

\*See Reservation Info for Booking Discount details

\*\* Chamber Member save an additional \$100 per person!



<b>RESERVATION FORM (INTL)</b> <b>HIGHLIGHTS OF ITALY'S</b> <b>AMALFI COAST</b> November 8, 2022 BOOKING #155075 (Web Code)	<b>Contact Information/Mail Reservation Form to:</b> York Region Chamber • ATTN: Linda Chisholm 1 Stone Wall Lane York, ME 03909 207.363.4422 • linda@yorkme.org
---	--

Make checks payable to: **CHAMBER EXPLORATIONS**

Enclosed please find a deposit in the amount of \$ \_\_\_\_\_ (\$500 per person) to secure reservations for \_\_\_\_\_ # of people.

I (We) wish to book the 2-night Rome Post Tour Extension\*\*\*:

☐ Yes \$595 pp dbl
 ☐ Yes +\$200 single
 ☐ No
 **\*\*\*Rome Extension must be booked at time of initial deposit**

Premier's Travel Protection Plan (TPP):  
**(TPP must be purchased with initial deposit)**
☐ Yes, I (we) wish to purchase travel protection (TPP)  
☐ No, I (we) decline travel protection (TPP)

Enclosed please find payment in the amount of \$ \_\_\_\_\_ (\$355 per person) to secure the Premier's Travel Protection Plan (TPP).

**TOTAL PAYMENT \$** \_\_\_\_\_

I (we) are members of the York Region Chamber of Commerce Yes \_\_\_\_\_ No \_\_\_\_\_

**RT AIR GATEWAY** \_\_\_\_\_ **ROOMMATE'S RT AIR GATEWAY** \_\_\_\_\_  
 see flyer page 3 for included group RT gateway/departure city, additional charges apply for other RT air packages

To avoid change fees, submit Passport names (first/mid/last) exactly as they appear on Passports

**Passport Name:** \_\_\_\_\_

DOB (MM/DD/YY) \_\_\_\_\_ Gender ☐ M ☐ F

Passport #: \_\_\_\_\_ Exp Date (MM/DD/YY) \_\_\_\_\_

Country of Issuance \_\_\_\_\_

**Roommate's Passport Name:** \_\_\_\_\_

DOB (MM/DD/YY) \_\_\_\_\_ Gender ☐ M ☐ F

Roommate's Passport #: \_\_\_\_\_ Exp Date (MM/DD/YY) \_\_\_\_\_

Country of Issuance \_\_\_\_\_

Street Address \_\_\_\_\_ ☐ Check if Roommate's address is the same

City \_\_\_\_\_ State \_\_\_\_\_ ZIP \_\_\_\_\_

Email address \_\_\_\_\_ Mbl# \_\_\_\_\_

Emergency Contact/Tel# \_\_\_\_\_

Notes: \_\_\_\_\_



Cardholder Name (If paying by credit card) \_\_\_\_\_

Credit Card # \_\_\_\_\_ Exp Date: \_\_\_\_\_

CVV# \_\_\_\_\_ Amount to be charged \$ \_\_\_\_\_

Credit Card Billing Address: ☐ Check if address is the same as above

Address \_\_\_\_\_ City \_\_\_\_\_

State \_\_\_\_\_ ZIP \_\_\_\_\_ Tel# \_\_\_\_\_

Sign \_\_\_\_\_ Date \_\_\_\_\_

**SIGNATURE REQUIRED** (for credit card use & acceptance of terms\*)

\*I (We) agree to pay according to the credit card issuer agreement. I understand and accept the cancellation fees/policy and other terms.

#### DEPOSIT & FINAL PAYMENT

Deposit of \$500 per person is due with Reservation Form to secure reservations. Final Payment Due Date is 75 days prior to departure.

#### \*BOOKING DISCOUNT

Make your Final Payment by check prior to the Final Payment Due Date & receive **\$400 per couple/\$200 per person Booking Discount!**

- Initial Deposit can be made by check or credit card to be eligible.
- Payments after Initial Deposit are considered part of Final Payment & must be made by check.

#### ONLINE BOOKING OPTION

Save time, postage & secure your seat for this group departure. Simply type <https://res.premierworlddiscovery.com> into your web browser & use the Booking Number (Web Code) from this flyer to make your Deposit online in just a few minutes. No need to submit a Reservation Form if booking online.

#### PREMIER'S TRAVEL PROTECTION PLAN (TPP) \$355 per person

(must purchase with Initial Deposit)

##### Part A – Cancellation Waiver provided by PWD/CE

I. Trip Cancellation Waiver (TCW) - Guarantees full refund on all payments, except the Trip Cancellation Waiver Fee itself in case of cancellation up to the time and date of departure due to the passenger's personal illness or death of an immediate family member. Medical/official documentation required.

II. Premier "Any Reason" Cancellation Waiver (ARCW) - Reimburses 75% of the cancellation fees in the form of a future travel credit certificate (FTCC) valid for 1 year, if you cancel more than 48 hours prior to scheduled departure for any reason not eligible for cash refund under the TCW (Part A – I). FTCC is non-transferable, may not be redeemed for cash and does not include any credit for the Trip Cancellation Waiver Fee. **The Trip Cancellation Waiver Fee must be paid for with Initial Deposit and is refundable until 180 days prior to departure.** The Trip Cancellation Waiver does not cover any single supplement charges due to an individual's traveling companion canceling prior to departure. The Trip Cancellation Waiver is non-transferable and valid for each applicant only. The Trip Cancellation Waiver does not cover any services such as airline tickets not purchased through PWD/CE. Cancellations, Refunds & Inquiries under Part A will be handled by PWD/CE. Certain Exclusions and Restrictions apply.

##### Part B – Post Departure Travel Protection Plan\* provided by USI

Includes coverage for: Trip Interruption (\$1,000); Trip Delay (\$100/Day-Max \$500); Baggage & Personal Effects (\$2,000); Baggage Delay (\$500); Emergency Accident/Sickness Medical Expense- excess coverage (\$30,000); Emergency Evacuation/Repatriation (\$150,000); Accidental Death & Dismemberment (\$25,000); Non-Insurance and Emergency Travel Assistance Services\*\* (24/7). Claims & Inquiries under Part B will be administered by USI.

For full Part A and Part B plan details visit: [res.premierworlddiscovery.com/TPP](https://res.premierworlddiscovery.com/TPP)  
All Benefits described on this page are for general information basis only. There are certain restrictions, exclusions and limitation that apply to all insurance coverages. Plan benefits, limits and provisions may vary by state jurisdiction.

#### \*\*NO RISK DEPOSIT - NO CHANGE FEES

Deposits & TPP payments for any Bookings made for this tour between Jan 1, 2021-Dec 31, 2022 are fully refundable until 180 days prior to departure, should your plans change inside of 180 days you can use the full value (Future Travel Credit\*\*) of your Deposit or TPP on a different program as long as you change plans or let us know prior to the Final Payment Due Date.

#### CANCELLATION FEES\*\*

Cancellations not covered by the Travel Protection Plan (TPP) or if the TPP is not purchased, are subject to the following per person fees:

- Cancel more than 180 days prior to departure: Full Refund
- Cancel 179-75 days prior to departure: Deposit or TPP\* is Retained\*\*
- Cancel 74-60 days prior to departure: 25% of total price
- Cancel 59-30 days prior to departure: 50% of total price
- Cancel 29-15 days prior to departure: 75% of total price
- Cancel 14 days or less prior to departure/no shows: No refunds

\*If purchased \*\*Future Travel Credit issued for Deposit or TPP\* value

#### RESPONSIBILITY

Premier World Tours LLC dba Chamber Explorations (hereafter PWD/CE), whose vouchers are used by respective agents for the passenger in all matters pertaining to hotel accommodations, sightseeing tours and transportation, hold themselves free of responsibility for any damages occasioned from any cause whatsoever. PWD/CE will not be responsible for any damages or inconvenience caused by late arrivals, departures and change of schedule or other conditions nor will they be responsible for any act, omission, or event during the time the passenger is not on board their conveyance. The passage contract in use by the airline concerned, when issued, shall constitute the sole contract between the airline and the purchaser of this tour/cruise, and/or passenger. PWD/CE does not hold any responsibility for the conduct of any of its members, hotel, motorcoach, cruiseline, train, airline or other personnel. PWD/CE reserves the right to decline to accept or retain any person as a member of a tour/cruise at its discretion. PWD/CE &/or its Tour Director retain the right to require any participant to withdraw from a tour/cruise at any time, if determined to be in the best interests of health, safety & general welfare of the tour/cruise group or of the individual participant. Arbitration- I/We agree, any and all disputes concerning this contract or any other material concerning the trip, or the trip itself must be resolved exclusively pursuant to binding arbitration in the state of California, pursuant to the then current rules of the American Arbitration Association. Payment of the deposit for this tour/cruise constitutes acceptance of these terms and conditions. CST #2048841-40

#### IMPORTANT CONDITIONS/NOTES

A valid US passport is required for this tour and is the responsibility of each passenger. Passports should be valid for up to six (6) months beyond the travel dates. All names must be submitted to Premier exactly as they appear on passenger passports. Itinerary and hotels are subject to change.

#### AIR NOTE

Air Schedules may not be available until Final Trip Documentation is received. Air seats are assigned by the airline and sometimes not assigned until the day of travel. Air seat changes can only be attempted upon receipt of e-tickets and Final Trip Documentation at which time availability may be limited. If specific seat assignments or airline choice is extremely important to your reservation, we recommend you book land only and make your own air reservations. Please make this adjustment to land only/own air at time of tour reservation.