

Exclusive Charter



York Regional Chamber presents



Wonders of the Danube River Cruise

featuring Budapest, Vienna & 7 Nights aboard the Amadeus Star

9 Days October 29, 2022



**BOOKING
DISCOUNT!**

Save \$200 per person
\$400 per couple*

*See Reservation Info for
Booking Discount details



9 Days October 29, 2022

Wonders of the Danube River Cruise

Day 1 - DEPART US - OVERNIGHT FLIGHT

Day 2 - ARRIVE BUDAPEST - BOARD SHIP

Meet Tour/Cruise Manager - Transfer & board **MS Amadeus Star** for 7 nights

Welcome Dinner Onboard - Ship docked overnight in Budapest



(D)

Overnight - Amadeus Star

Day 3 - BUDAPEST - ESZTERGOM

Morning **Budapest City Tour** - Ship departs Budapest after lunch

Afternoon cruising or *Optional Esztergom, Visegrad Castle & Szentendre*



(B,D)

Overnight - Amadeus Star

Day 4 - BRATISLAVA

Morning **Bratislava City Tour** - Ship docked in Bratislava late into the evening

Afternoon at Leisure or *Optional Schloss Hof Palace & Estate*



(B,L,S & D)

Overnight - Amadeus Star

Day 5 - VIENNA

Morning **Vienna City Tour** - Ship docked in Vienna late into the evening

Afternoon at Leisure or *Optional to Schoenbrunn Palace*



(B,L,S & D)

Overnight - Amadeus Star

Day 6 - DURNSTEIN - MELK/EMMERSDORF

Morning **Durnstein Walking Tour & Abbey**

Afternoon cruising or *Optional Wachau Valley Winery & Tasting*



(B,L,S & D)

Overnight - Amadeus Star

Day 7 - LINZ - PASSAU - SALZBURG OPTIONAL

Morning Linz stop - Danube Cruising- Relax onboard or *Optional Full-day excursion to Salzburg including Salzkammergut and Lunch* - **Gala Farewell Dinner Onboard**



(B,L,S & D)

Overnight - Amadeus Star

Day 8 - REGENSBURG

Morning **Regensburg Walking Tour** - Ship docked in Regensburg into the evening

Afternoon at Leisure or *Optional Danube Gorge, Weltenburg Abbey & Beer Tasting*

Bavarian Dinner Onboard



(B,L,S & D)

Overnight - Amadeus Star

Day 9 - PASSAU - MUNICH - FLIGHT HOME OR PRAGUE 2 NIGHT EXTENSION

Disembark Passau - Transfer to Munich Airport - Fly Home or 2 Night Prague Ext.



(B)

B-Breakfast Hotel/Onboard • S-Snacks Onboard afternoon and/or evening

L-Lunch Onboard • D-Dinner Onboard with Beer & Regional Wines

CITIES & PORTS

BUDAPEST, HUNGARY

Budapest is one of Europe's most beautiful cities. The city straddles both banks of the Danube linked by seven bridges including the famous Chain and Elizabeth Bridges. An included sightseeing tour presents you with a fantastic opportunity to become acquainted with Hungary's beautiful capital. Enjoy a photo stop at Gellert Hill, see historic Buda Castle, 500-year-old Matthias Church, St. Stephen's Basilica, the distinctive Fisherman's Bastion and the marvelous Royal Palace.

BRATISLAVA, SLOVAKIA

Awake today in the capital city of Bratislava in Slovakia. Enjoy a Bratislava City Tour and walk through the city, see the home of the Slovak Philharmonic Orchestra, the old city walls, the summer residence of the archbishop and the current residence of the president of Slovakia. Traverse through the restored old town, from Michael's Gate, and admire other impressive sights such as the Primatial Palace and St. Martin's Cathedral, former coronation cathedral for Hungarian kings. Bratislava is a little jewel along the Danube.

VIENNA, AUSTRIA

Enjoy an included Vienna City Tour. For over 600 years, the magnificent baroque capital city of Vienna was the seat of the mighty Hapsburg Emperors, a heritage that has bestowed it with many dazzling palaces and monuments: the lavish Hofburg Palace, the impressive Vienna Opera House and the majestic Ringstrasse. The capital is also known as the "City of Music" for having once been the home of composers such as Beethoven, Schubert, Mozart and Johann Strauss. Maybe visit the Schoenbrunn Palace.

DURNSTEIN, AUSTRIA

The romantic Wachau Valley is one of the most beautiful regions of Austria. Visit Durnstein, a town well-known for its first-class wines and Abbey, which you visit during the morning sightseeing walk. This afternoon maybe enjoy a wine experience with an optional to the Wachau Valley for a Winery visit & Tasting.

REGENSBURG, GERMANY

Situated in Eastern Bavaria, Regensburg is one of Germany's oldest towns, founded by the Romans in 179 A.D. Today it is a prosperous city with 3 universities and many landmarks dated to the Middle Ages. Enjoy a Regensburg Walking Tour through one of the most visited cities in Germany and its Medieval Old Town, a UNESCO World Heritage site. This afternoon an excursion will be available to the Weltenburg Abbey.

SALZBURG, AUSTRIA - OPTIONAL FULL DAY EXCURSION

Travel to Salzburg for a walking tour of the famous Old Town, Mirabel Gardens, Mozart Square, the Dom Cathedral and historic center made famous by the "Sound of Music." Wander by Mozart's Birthplace located at No. 9 Getreidegasse, the home where the Mozart family lived from 1747-1773. After an included lunch, head to the picturesque village of Mondsee, another film location of "The Sound of Music". Enjoy the beautiful scenery as you return to the ship.

Optional 2 Night Prague Post Cruise Extension

\$695 pp dbl +\$250 single supplement

Day 9 Passau - Prague, Czech Republic

Board Motorcoach - Travel & Arrive Prague for 2 nights at a hotel

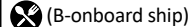

(B-onboard ship)

Overnight - Prague

Day 10 Prague

Prague City Tour - Prague Castle, Charles Bridge & St. Vitus Cathedral

Afternoon at Leisure - **Prague Dinner & Folklore Show**

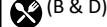

(B & D)

Overnight - Prague

Day 11 Prague - Flight Home

Transfer to Prague Airport - Flight Home



(B)

Prague Extension Includes: Transportation to Prague, 2 Nights Hotel - Prague, Tour Manager, 3 Meals: 2-B & 1-D, Prague City Tour & Transfer to Prague Airport

Notes: Prague Extension must be booked at time of deposit. Due to group air policies

outbound air on 10/29/2022 could be a different schedule than the rest of your group for Prague extension passengers. • Prague Ext is based on 20 passenger minimum



MS Amadeus Star



Fine Dining



Fitness Center

AMADEUS STAR

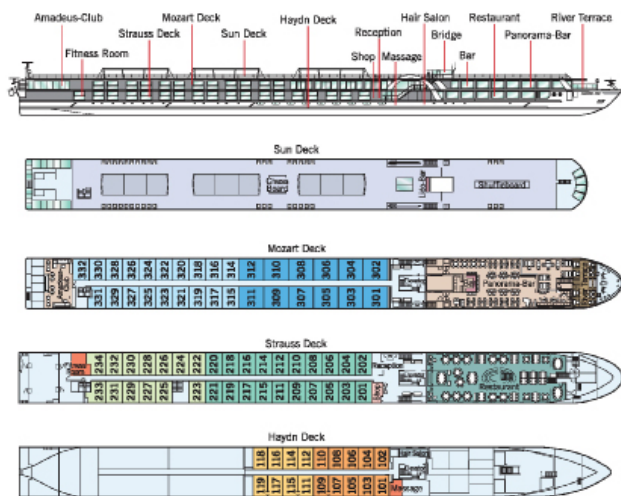

THE SHIP - MS AMADEUS STAR

The innovative 164 passenger *Amadeus Star*, launched in 2019, offers all the amenities of a floating 5-star hotel. This Premium cruise ship features the most modern furnishings that blend masterfully with the architecture of the ship and a luxurious design that is the hallmark of the Amadeus fleet. The extensive Restaurant and the Panorama Bar offer divine views of the passing riverscapes, and the glass-shielded River Terrace allows you to relax in the open air. The attentive English-speaking onboard service staff will see to your comfort with typical European hospitality. The cabin design plans are forward-thinking, bright & modern, all part of a premium focus with 70 large Staterooms & 12 Suites. The beauty of river cruising is that the most interesting destinations come to you. This Star charter features English-only onboard commentary with inclusive shore excursions balanced with choice to simply relax onboard, get a spa treatment or add sightseeing with optional excursions.

ALL MEALS INCLUDED ONBOARD

Three meals daily are served graciously in the exquisite restaurant and feature local & international specialties. All dinners are four courses and are served with included regional wines & beer. While dining, you have splendid views of the passing scenic landscapes through the large picture windows. Enjoy afternoon and/or late evening snacks in the lounge based on the daily schedule.

COMFORTABLE & INNOVATIVE STATEROOMS

After boarding, unpack once. All staterooms are larger than traditional river cruise cabins & offer excellent river views. The Mozart Deck features 12 Suites with Walk Out Balconies. The other 19 Staterooms on the Mozart Deck & 33 Staterooms on the Strauss Deck feature an innovative Drop-Down Panoramic Window. The 18 Staterooms on the Haydn Deck have a fixed window. All staterooms are fully equipped with comfortable & modern furnishings including flat screen TV & large private bathrooms with shower.

SHIP TECHNICAL DATA

Launched:	2019	Max passengers:	164
Decks:	4	Crew members:	40
Length/ Width (ft):	443/37.5	Cabins/Suites:	70/12

INCLUSIONS

- Roundtrip Airfare - BOS
- Roundtrip Transfers - BOS
- 7 Night Cruise - Outside Cabin
- 20 Meals (7-B, 6-L & 7-D)
- CE Tour/Cruise Manager
- Regional Wine & Beer with Dinners
- Ship Staff
- Baggage Handling at Hotel & Ship
- Int'l Air Taxes/Fuel/Port Charges
- Wifi Onboard
- Hotel & Ship Transfers

EXCURSIONS/TOURS

- Budapest City Tour
- Bratislava City Tour
- Vienna City Tour
- Dürnstein Walking Tour & Abbey
- Regensburg Walking Tour
- Extended Port Time in Budapest, Vienna, Bratislava & Regensburg
- Welcome & Farewell Dinners
- Bavarian Dinner Onboard

RATES

Cat E - Haydn Deck	\$4095 pp dbl*	\$3895 pp dbl with BD**	+\$950 single
Cat D - Haydn Deck	\$4295 pp dbl*	\$4095 pp dbl with BD**	+\$950 single
Cat C - Strauss Deck	\$4695 pp dbl*	\$4495 pp dbl with BD**	+\$1500 single
Cat B - Strauss Deck	\$4895 pp dbl*	\$4695 pp dbl with BD**	+\$1500 single
Cat A - Mozart Deck	\$5095 pp dbl*	\$4895 pp dbl with BD**	+\$1900 single
Suite - Mozart Deck	\$5495 pp dbl*	\$5295 pp dbl with BD**	+\$2300 single

Booking Discount - \$400 per couple/\$200 pp

**Chamber Member save an additional \$100 per person

STATEROOMS & SUITES



STATEROOMS - 172 or 188 SQ FT

All staterooms feature 2 twin beds that can be separated or put together, flat screen TV, private bath with shower, hair dryer, closet, phone, desk, chair & safe. Mozart & Strauss Staterooms feature Drop Down Panoramic Window with 188 sq. ft. of floor space. Haydn Deck Staterooms feature a fixed window with 172 sq ft. (stateroom size & amenities can vary)

Stateroom Haydn Deck (172 sf)

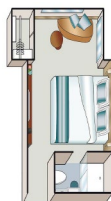

Stateroom Strauss & Mozart Decks (188 sf)

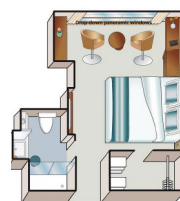

SUITE - 284 SQ FT WITH BALCONY

All suites are on the Mozart Deck and have panoramic windows with exterior Walk Out Balcony, two twin beds that can be separated or put together, a private sitting area, flat screen TV, mini-bar, private bath with shower, hair dryer, phone, closet, desk, chair, safe & offer 284 square feet of floor space. (Suite size and amenities can vary)

Suite Mozart Deck (284 sf)



Reservation Form (River Cruise)

Wonders of the Danube River Cruise
October 29, 2022
Booking #155074 (Web Code)

Contact Information/Mail Reservation Form to:

York Region Chamber • ATTN: Linda Chisholm
1 Stone Wall Lane
York, ME 03909
207.363.4422 • linda@yorkme.org

Cabin Category Requested: (All Cabin Categories are on a space available basis)

Cat E: ☐ Cat D: ☐ Cat C: ☐ Cat B: ☐ Cat A: ☐ Suite: ☐

Enclosed please find a deposit in the amount of \$ _____ (\$500 per person)
to secure reservations for _____ # of people.

Travel Protection Plan (TPP) ☐ Yes, I (we) wish to purchase travel protection (TPP)
☐ No, I (we) decline travel protection (TPP)

Enclosed please find payment in the amount of \$ _____ (\$440 per person)
to secure the Premier's Travel Protection Plan (TPP). (TPP must be purchased with initial deposit)

I / we want to purchase the Prague Post Extension*** (\$695 pp dbl/+\$250 SS) ☐ Yes ☐ No

***Please book Prague Ext with initial deposit.

TOTAL PAYMENT \$ _____ Make checks payable to: **CHAMBER EXPLORATIONS**

I (we) are members of the **York Region Chamber of Commerce**: Yes ☐ No ☐

RT AIR GATEWAY _____ ROOMMATE'S RT AIR GATEWAY _____

see flyer page 3 for included group RT gateway/departure city, additional charges apply for other RT air packages

To avoid change fees, submit Passport names (first/mid/last) exactly as they appear on Passports

Passport Name: _____

DOB (MM/DD/YY) _____ Gender ☐ M ☐ F

Passport #: _____ Exp Date (MM/DD/YY) _____

Country of Issuance _____

Roommate's Passport Name: _____

DOB (MM/DD/YY) _____ Gender ☐ M ☐ F

Roommate's Passport #: _____ Exp Date (MM/DD/YY) _____

Country of Issuance _____

Street Address _____ ☐ Check if Roommate's address is the same

City _____ State _____ ZIP _____

Email address _____ Mbl# _____

Emergency Contact/Tel# _____

Notes: _____



Cardholder Name (If paying by credit card) _____

Credit Card # _____ Exp Date: _____

CVV# _____ Amount to be charged \$ _____

Credit Card Billing Address: ☐ Check if address is the same as above

Address _____ City _____

State _____ ZIP _____ Tel# _____

Sign _____ Date _____

SIGNATURE REQUIRED (for credit card use & acceptance of terms*)

*I (We) agree to pay according to the credit card issuer agreement. I understand and accept the cancellation fees/policy and other terms.

DEPOSIT & FINAL PAYMENT

An Initial Deposit of \$500 per person is due with Reservation Form to secure reservations. Final Payment Due Date is 90 days prior to departure.

***BOOKING DISCOUNT**

Make your Final Payment by check prior to the Final Payment Due Date

& receive **\$400 per couple/\$200 per person Booking Discount!**

• Initial Deposit can be made by check or credit card to be eligible.

• Payments after Initial Deposit are part of Final Payment & must be made by check.

ONLINE BOOKING OPTION

Save time, postage & secure your seat for this group departure. Simply type: <https://res.chamberexplorations.com> into your web browser & use the Booking Number (Web Code) from this flyer to make your Deposit online in just a few minutes. No need to submit a Reservation Form if booking online.

PREMIER'S TRAVEL PROTECTION PLAN (TPP) \$440 per person
(must purchase with Initial Deposit)

Part A – Cancellation Waiver provided by PWD/CE

I. Trip Cancellation Waiver (TCW) - Guarantees full refund on all payments, except the Trip Cancellation Waiver Fee itself in case of cancellation up to the time and date of departure due to the passenger's personal illness or death of an immediate family member. Medical/official documentation required.

II. Premier "Any Reason" Cancellation Waiver (ARCW) - Reimburses 75% of the cancellation fees in the form of a future travel credit certificate (FTCC) valid for 1 year, if you cancel more than 48 hours prior to scheduled departure for any reason not eligible for cash refund under the TCW (Part A – I.). FTCC is non-transferable, may not be redeemed for cash and does not include any credit for the Trip Cancellation Waiver Fee. **The Trip Cancellation Waiver Fee must be paid for with Initial Deposit and is refundable until 180 days prior to departure. The Trip Cancellation Waiver does not cover any single supplement charges due to an individual's traveling companion canceling prior to departure.** The Trip Cancellation Waiver is non-transferable and valid for each applicant only. The Trip Cancellation Waiver does not cover any services such as airline tickets not purchased through PWD/CE. Cancellations, Refunds & Inquiries under Part A will be handled by PWD/CE. Certain Exclusions and Restrictions apply.

Part B – Post Departure Travel Protection Plan* provided by USI

Includes coverage for: Trip Interruption (\$1,000); Trip Delay (\$100/Day-Max \$500); Baggage & Personal Effects (\$2,000); Baggage Delay (\$500); Emergency Accident/Sickness Medical Expense- excess coverage (\$30,000); Emergency Evacuation/Repatriation (\$150,000); Accidental Death & Dismemberment (\$25,000); Non-Insurance and Emergency Travel Assistance Services** (24/7). Claims & Inquiries under Part B will be administered by USI.

For full Part A and Part B plan details visit: premierworlddiscovery.com/TPP
All Benefits described on this page are for general information basis only. There are certain restrictions, exclusions and limitation that apply to all insurance coverages. Plan benefits, limits and provisions may vary by state jurisdiction.

CANCELLATION FEES

Cancellations are subject to the following per person fees;

- Cancel 180 days prior to departure:	\$200 pp is retained
- Cancel 179-90 days prior to departure:	Deposit or TPP** is retained
- Cancel 89-60 days prior to departure:	50% of total price
- Cancel 59-30 days prior to departure:	75% of total price
- Cancel 29 days or less prior to departure/no shows:	No refunds

**If TPP purchased

RESPONSIBILITY

Premier World Tours LLC dba CHAMBER EXPLORATIONS (hereafter PWD/CE), whose vouchers are used by respective agents for the passenger in all matters pertaining to hotel accommodations, sightseeing tours and transportation, hold themselves free of responsibility for any damages occasioned from any cause whatsoever. PWD/CE will not be responsible for any damages or inconvenience caused by late arrivals, departures and change of schedule or other conditions nor will they be responsible for any act, omission, or event during the time the passenger is not on board their conveyance. The passage contract in use by the airline concerned, when issued, shall constitute the sole contract between the airline and the purchaser of this tour/cruise, and/or passenger. PWD/CE does not hold any responsibility for the conduct of any of its members, hotel, motorcoach, cruiseline, train, airline or other personnel. PWD/CE reserves the right to decline to accept or retain any person as a member of a tour/cruise at its discretion. PWD/CE &/or its Tour Director retain the right to require any participant to withdraw from a tour/cruise at any time, if determined to be in the best interests of health, safety & general welfare of the tour/cruise group or of the individual participant. Arbitration- I/We agree, any and all disputes concerning this contract or any other material concerning the trip, or the trip itself must be resolved exclusively pursuant to binding arbitration in the state of California, pursuant to the then current rules of the American Arbitration Association. Payment of the deposit for this tour/cruise constitutes acceptance of these terms and conditions. CST #2048841-40

IMPORTANT CONDITIONS/NOTES

• A valid US passport is required for this tour and is the responsibility of each passenger. Passports should be valid for up to six (6) months beyond the travel dates. All names must be submitted to Premier exactly as they appear on passenger passports.

• Itinerary and hotels are subject to change.

AIR NOTE

Air Schedules may not be available until Final Trip Documentation is received. Air seats are assigned by the airline and sometimes not assigned until the day of travel. Air seat changes can only be attempted upon receipt of e-tickets and Final Trip Documentation at which time availability may be limited. If specific seat assignments or airline choice is extremely important to your reservation, we recommend you book land only and make your own air reservations. Please make this adjustment to land only/own air at time of tour reservation.

