



presented by **Continental**

## NIBA 2023 Annual Convention

### Exhibit Booth Assignments

<b>Booth #</b>	<b>Company</b>	<b>Booth #</b>	<b>Company</b>
419	4B Components, Ltd.	617	Mantis Conveyor Products
315	AccuPad, Inc	114	Martin Sprocket
214	AFC Materials Group	507	Maxilift Inc
515	Almex Group	518	Mehler Engineered Products
116	American Eagle Manufacturing LLC	201	Minet Lacing Technology, Inc.
115	Ammega Group	610	Modutech
416	Arch	606	NIBA - The Belting Association
301	Argonics Inc	300	Nitta Corporation of America
314	ASGCO - Complete Conveyor Solutions	317	Normac Adhesives Inc.
404	Behabelt USA	319	Novex Inc
202	Belt Concepts of America Inc.	103	Optibelt Corporation
208	Beltservice Corporation	609	PANG Industrial
409	Benetech, Inc.	219	Passaic Rubber Company
104	BRECOflex CO LLC	508	Pelosi SRL
614	Brelko Conveyor Products, Inc.	504	POBCO, Inc.
200	Cambelt	718	Prairie Belting Inc
611	Chemi-Flex	217	Precision Pulley and Idler
410	Chiorino America, Inc.	619	PROBANDAS AMERICA LLC
415	COBRA America (Depreux)	500	RAM Enterprise Inc
616	Comercial Química Massó, S.A.	215	Reichel-Korfmann Co Inc.
109	Continental	119	REMA TIP TOP - NA
411	Conveyor Accessories / Mato Corp.	309	Richwood
400	Derco BV	405	Sati Group spa
706	Divya Beltech, Inc.	310	Semperit
511	Esgand USA Inc. (Max Schlatterer GmbH + Co. KG)	102	Service First Processing
519	Esbelt Corporation	418	Shingle Belting Company
502	Everhard Products, Inc.	716	SIT Elatech Inc
417	Fenner Drives Inc	402	Smiley Monroe Inc
408	Fenner Dunlop Conveyor Belting	308	Souhegan Wood Products Inc
203	Flexco	401	STARK Vulcanizing Products BV
615	Fonmar Group S.L.	305	Thermoid
414	Forbo Transtex	618	Trelleborg Slovenija d.o.o.
218	Gates TPU	510	Uniband USA
403	GRT Rubber Technologies	209	Universal Belting Resource
514	Habasit America	708	US Rubber Corporation
516	ICL America	710	US Timing and Conveyor
509	Konus Konex	302	VDG (Van der Graaf)
101	Legg Company Inc	318	YongLi America
303	Luff Industries Ltd	608	Ziligen A.S.
607	Mafdel		

# NATL INDUSTRIAL BELTING ASSN - ANNUAL CONV

09/14/23 - 09/14/23

OMNI NASHVILLE HOTEL - BROADWAY BALLROOM - NASHVILLE, TN



## REVISION

Date: 3/27/2023

By: Wilfred Wallen

## BOOTH COUNT

Inventory as of 03/27/2023

Dimension	Size	Qty	SqFt
10'x10'	100	94	9,400
Totals:		94	9,400

## BLDG. LEGEND:

Rigging Point  
1,000 lbs.

EXIT SIGN

- 400A 3Ø 480V Female Cam-Lok
- 400A 3Ø 120/208V Female Cam-Lok
- 200A 3Ø 120/208V Female Cam-Lok
- 100 Amp 3Ø 120/208V Female Cam-Lok
- 3ØA 3Ø

## CEILING HEIGHT - BROADWAY

AIR WALL TRACK SOFFIT HEIGHT  
23'-11"

CHANDELIER HEIGHT  
21'-11"

UPPER CHANDELIER HARD SOFFIT  
25'-10"

TILES AROUND CHANDELIER  
28'-10"

## CEILING HEIGHT - LEGENDS

AIR WALL TRACK SOFFIT HEIGHT  
21'-11"

CHANDELIER HEIGHT  
N/A

UPPER CHANDELIER HARD SOFFIT  
22'-7"

TILES AROUND CHANDELIER  
24'-7"

## DRAWING INFO

Passport Line Item Number:

**#10239548**

Facility:

OMNI NASHVILLE HOTEL

Facility Location:

BROADWAY BALLROOM

City & State:

NASHVILLE, TN

Scale: CUSTOM

Project #: 522532

Acct. Sales: JIM POWERS

Acct. Mgmt.: YAZMIN FRANZ

Started: 3/22/2023

Started By: WILFRED WALLEN

Prod. Branch: NASHVILLE

**Freeman.**

**Disclaimer** - This floor plan is preliminary and subject to change pending review and official approval by all authorities having jurisdiction. Every effort has been made to ensure the accuracy of all information contained on this floor plan. However, no warranties, either expressed or implied, are made with respect to this floor plan. If the location of building columns, utilities or other architectural components of the facility is a consideration in the construction or usage of an exhibit, it is the sole responsibility of the exhibitor to physically inspect the facility to verify all dimension and locations.  
© Copyright 2023, Freeman Co. All rights reserved.

**Confidential and Proprietary** - the information contained herein is the proprietary information of Freeman and by accessing the information, the recipient agrees to keep the information confidential and not disclose it to any third party without the prior consent of Freeman. Recipient also agrees to only use the information for its internal evaluation purposes and for no other purpose, without the prior consent of Freeman.

# NATL INDUSTRIAL BELTING ASSN - ANNUAL CONV

09/14/23 - 09/14/23

OMNI NASHVILLE HOTEL - BROADWAY BALLROOM - NASHVILLE, TN

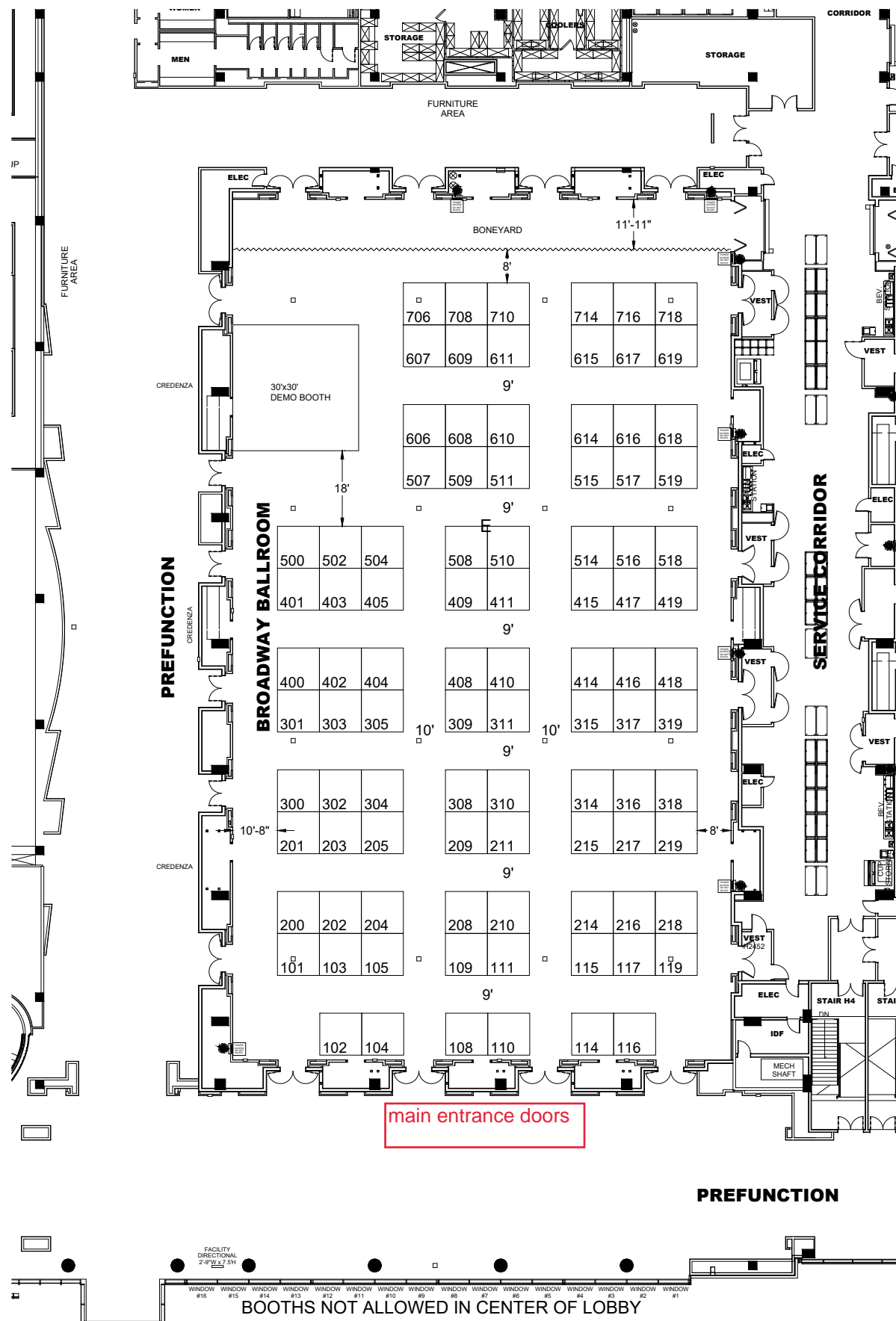

## REVISION

Date: 3/27/2023

By: Wilfred Wallen

## BOOTH COUNT

Inventory as of 03/27/2023

Dimension	Size	Qty	SqFt
10'x10'	100	94	9,400
Totals:		94	9,400

## BLDG. LEGEND:

Rigging Point  
1,000 lbs.

EXIT SIGN

- 400A 3Ø 480V Female Cam-Lok
- 400A 3Ø 120/208V Female Cam-Lok
- 200A 3Ø 120/208V Female Cam-Lok
- 100 Amp 3Ø 120/208V Female Cam-Lok
- 3ØA 3Ø

## CEILING HEIGHT - BROADWAY

AIR WALL TRACK SOFFIT HEIGHT  
23'-11"

CHANDELIER HEIGHT  
21'-11"

UPPER CHANDELIER HARD SOFFIT  
25'-10"

TILES AROUND CHANDELIER  
28'-10"

## CEILING HEIGHT - LEGENDS

AIR WALL TRACK SOFFIT HEIGHT  
21'-11"

CHANDELIER HEIGHT  
N/A

UPPER CHANDELIER HARD SOFFIT  
22'-7"

TILES AROUND CHANDELIER  
24'-7"

## DRAWING INFO

Passport Line Item Number:

**#10239548**

Facility:

OMNI NASHVILLE HOTEL

Facility Location:

BROADWAY BALLROOM

City & State:

NASHVILLE, TN

Scale: CUSTOM

Project #: 522532

Acct. Sales: JIM POWERS

Acct. Mgmt.: YAZMIN FRANZ

Started: 3/22/2023

Started By: WILFRED WALLEN

Prod. Branch: NASHVILLE



**Disclaimer** - This floor plan is preliminary and subject to change pending review and official approval by all authorities having jurisdiction. Every effort has been made to ensure the accuracy of all information contained on this floor plan. However, no warranties, either expressed or implied, are made with respect to this floor plan. If the location of building columns, utilities or other architectural components of the facility is a consideration in the construction or usage of an exhibit, it is the sole responsibility of the exhibitor to physically inspect the facility to verify all dimension and locations.  
© Copyright 2023, Freeman Co. All rights reserved.

**Confidential and Proprietary** - the information contained herein is the proprietary information of Freeman and by accessing the information, the recipient agrees to keep the information confidential and not disclose it to any third party without the prior consent of Freeman. Recipient also agrees to only use the information for its internal evaluation purposes and for no other purpose, without the prior consent of Freeman.

File Path: C:\Vault\Designs\Projects\NIBA Annual Conv & Expo\NIBA2309\Floor Plans\NIBA23.dwg | Tab Name: L10239548 FP