



**L&L SEMINAR – FEBRUARY 10, 2020**

**RISA 3D & RISA Foundation**

**2 Locations – Minneapolis & Duluth\*\*\***

Please join us for the following Lunch and Learn seminar. There will be two separate sessions at two separate sites as outlined below. **Please indicate which sessions you are planning to attend at which site when you RSVP.**

## CLASS AGENDA

**11:30AM – Lunch & Registration & Introductions**

**12:00PM – 1:00PM Presentation Session #1 - Tips & Tricks for the All New RISA-3D:**

The All New RISA-3D provides engineers with a fresh new take on the most popular 3D general analysis and design software available. With a completely redesigned interface, robust graphical modeling tools, expanded detailed reports and multi-core processing, RISA-3D v18 allows engineers to work more efficiently and get the most out of the software.

In this presentation you will learn how to:

- Streamline your daily use of RISA-3D with the updated interface
- Effortlessly make model changes with graphical selection and the Properties Panel
- Easily validate member design with expanded detail reports
- Utilize an updated interface and dynamic print preview to create robust reports

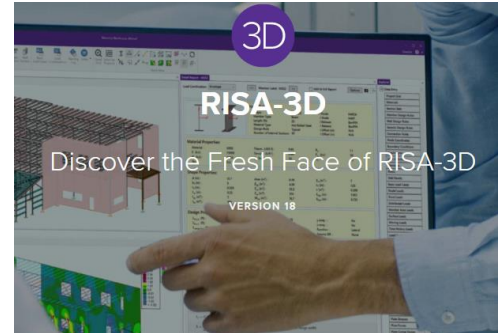

**1:00PM – 1:10PM Break**

**1:10PM – 2:10PM Presentation Session #2 – RISA Foundation:** Whether you are designing mat slabs or retaining walls, RISA Foundation gives you a comprehensive set of modeling tools to create foundation elements with virtually any shape or configuration. This presentation will cover how to model from scratch as well as utilize results from RISA-3D to analyze and design all different types of foundation elements.

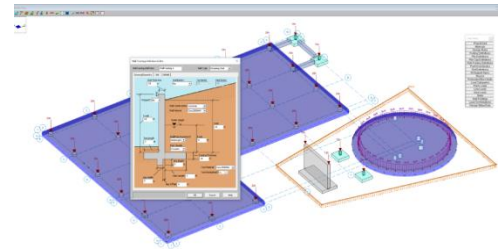

For more info please visit: <https://risa.com/products/risa-3d>

**Presenter Bio:** Ben Follett, PE is a licensed engineer in Pennsylvania and joined RISA in 2018 as the Product Marketing Manager. In his role, he is involved in all aspects of product marketing and sales while also focused on helping engineering firms streamline and integrate their 3D engineering workflows. Prior to his work in the software industry, he was a structural associate with Michael Baker International, one of the Engineering News Record Top 500 firms. Douglas L. Fell, PE

**Certificates for 1 PDH  
will be provided at the end of  
the seminar for MN Pes per  
each session.**

## LOCATIONS:

**Site#1:** [Barr Engineering Co.](http://www.barr.com), 4300 MarketPointe Drive, Minneapolis, MN 55435 (Presenter will be in person at this location)

**Site#2:** Looking for a member firm conference room in Duluth (Presentation will be broadcasted live from Minneapolis location.)

(\*\*\*This location to be confirmed based on number of attendees and availability of venue.)

## COST:

Free. Lunch will be provided for those who RSVP. Please RSVP to John Krapek at [john@acecmn.org](mailto:john@acecmn.org) (952-593-5533) **by January 31, 2020.** If have any questions about this seminar, please contact Mustafa B. Igdelioglu with Barr Engineering Co. at 952-832-2709 or e-mail: [migdelioglu@barr.com](mailto:migdelioglu@barr.com).

**Due to conference room sizes, space is limited so sign up early!**