

Steel Bridge Projects in Minnesota

Kevin Western | State Bridge Engineer

October 26, 2021



Recent Projects

TH 53 over Rouchleau Pit (69129)

- 3 span, continuous, haunched steel girder bridge
- 270'-480'-375' span configuration
- Opened to traffic: September 2017

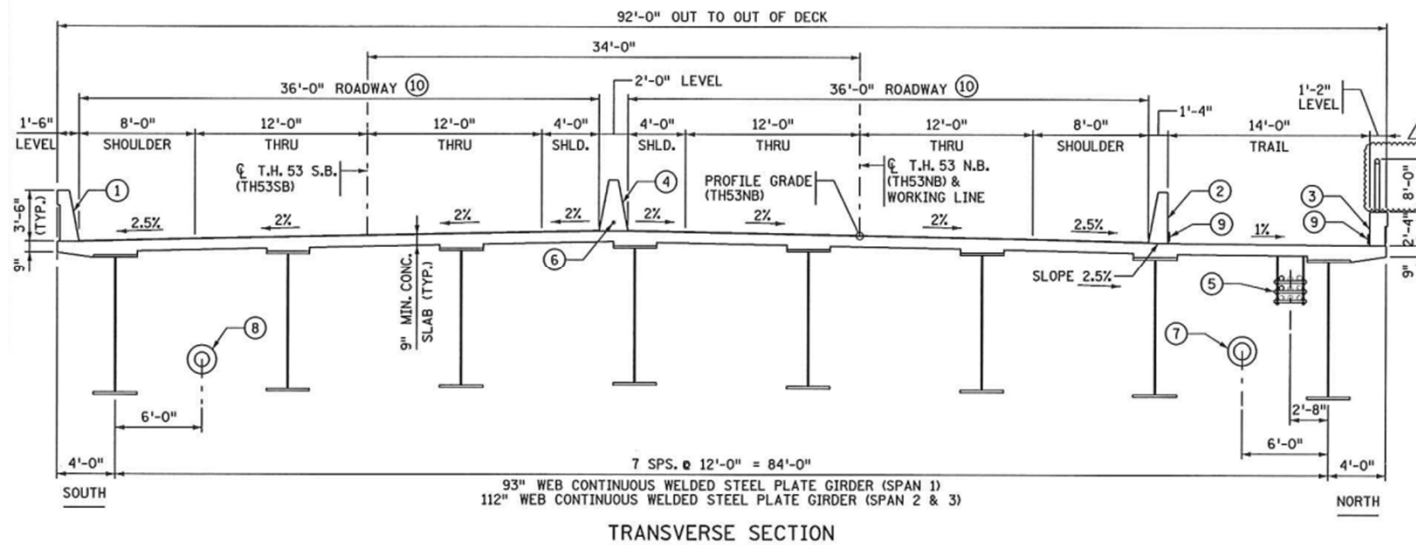

TH 53 over Rouchleau Pit (69129)

- Used Construction Manager/General Contractor (CMGC) delivery method
- Used additional steel weight in webs and flanges to cut down on fabrication cost

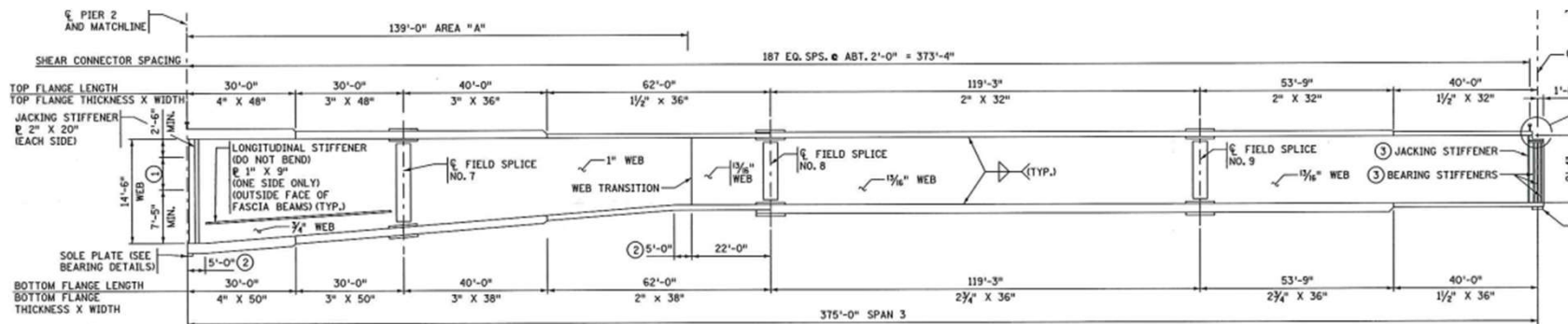

Red Wing Bridge (25033)

- TH 61 over the Mississippi River
- Minnesota-Wisconsin border bridge
- Delivered Design-Bid-Build with in-house design and WisDOT peer review
- Opened to traffic: November 2019



Red Wing (25033)

- Second steel tub girder bridge in Minnesota
- 221'-432'-292' spans for steel tub unit
- Minimum depth is 8'-6"
- Maximum depth at piers is 13'-6"

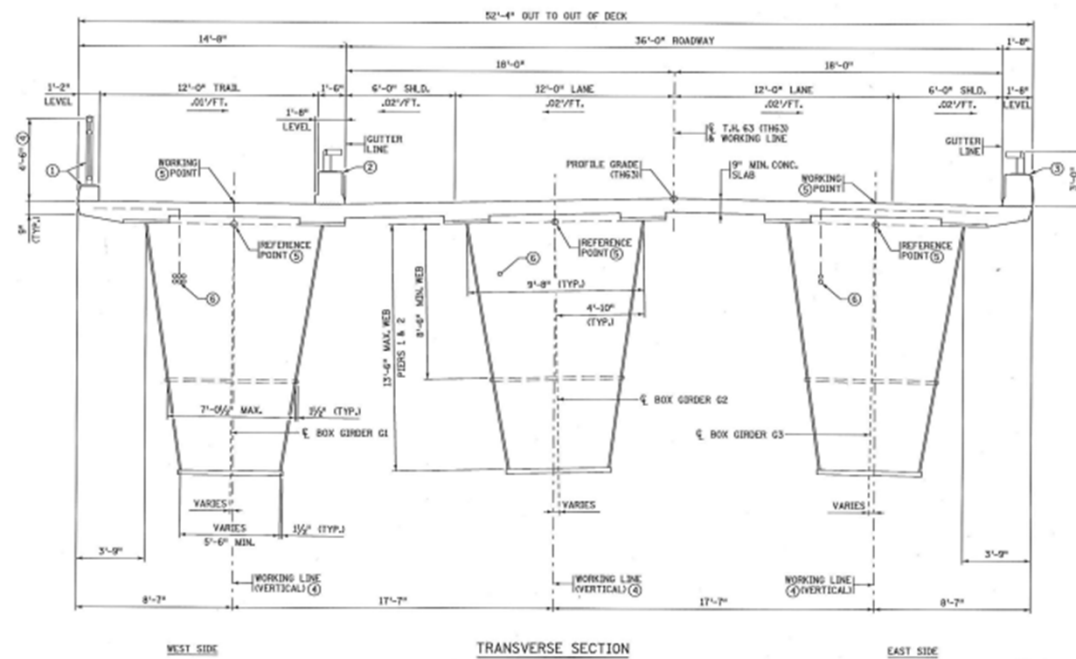

Baudette (39016)

- TH 72 over Rainy River
- Border bridge between Minnesota and Ontario
- Haunched plate girder beams
- Opened to traffic: September 2020



Baudette (39016)

- 5 span structure
- 220'-300'-300'-300'-220'
- Web depth varies from 80" to 140"

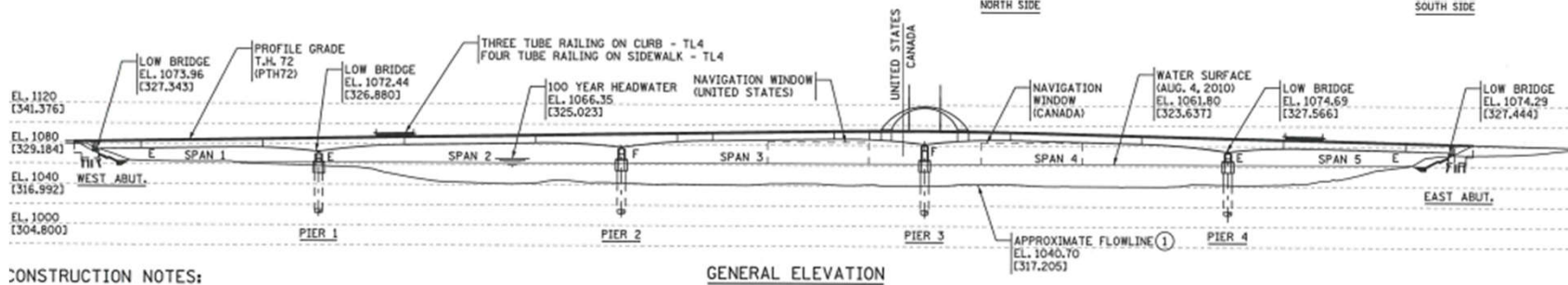
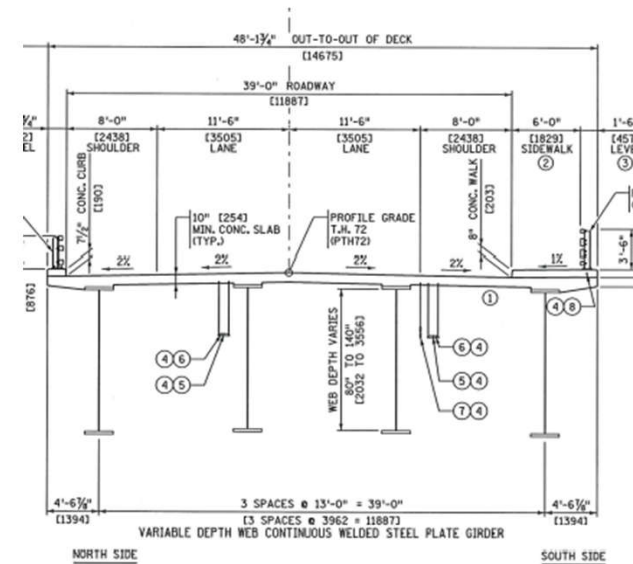

CONSTRUCTION NOTES:

GENERAL ELEVATION

Twin Ports Interchange

- I-35/I-535/US-53 interchange project in Duluth
- 3 new steel girder bridges (69902, 69904, 69905)
- Currently under construction
- First steel girders estimated to be set in January 2022

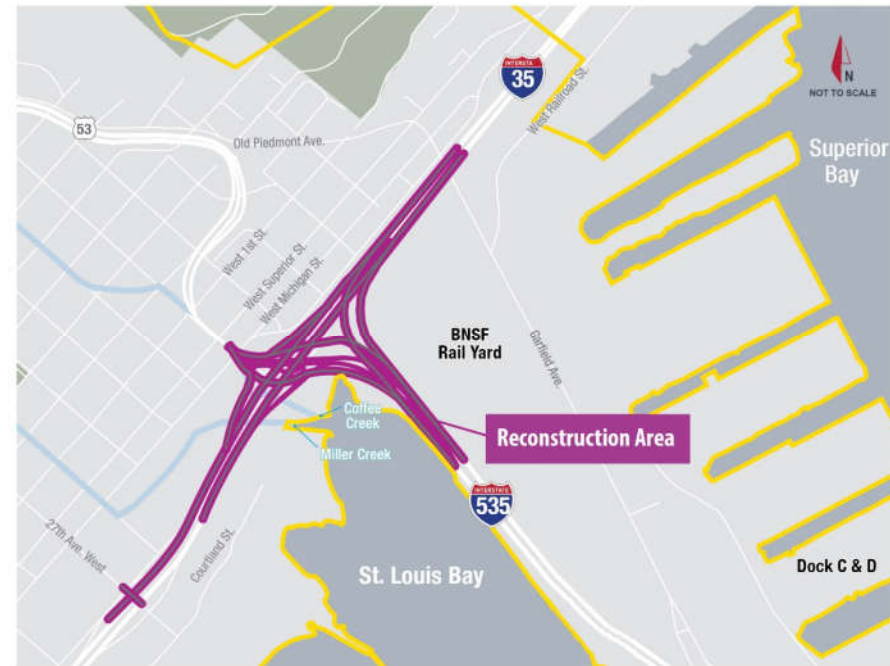

Twin Ports Interchange

Bridge Number	Span Configuration	Web Depth
69902	230'-221'-163'-188'	90"
69904	183'-154'-182'-181'-180'-154'	72"
69905	195'-221'	87", 93"



Potential Projects

- 494 Design Build Project

- Flyover ramp bridge
- 35W NB to 494 WB

- 9289 replacement

- CP Rail over 494
- Through girder

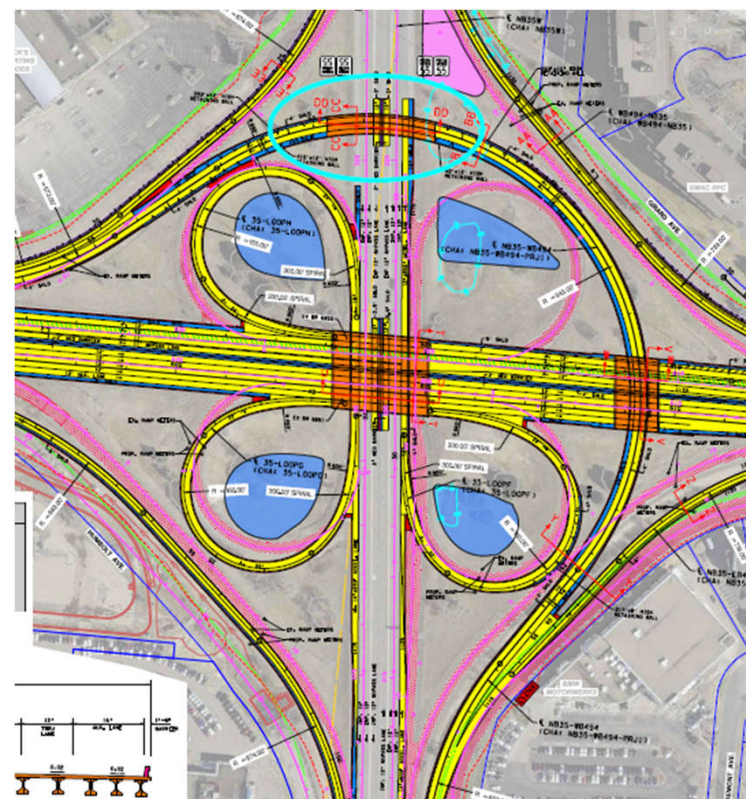

Moorhead

- CMGC Moorhead Grade Separation (14016)
 - BNSF over 11th Street North
 - Could be single span or three span
 - Proposed letting January 2023

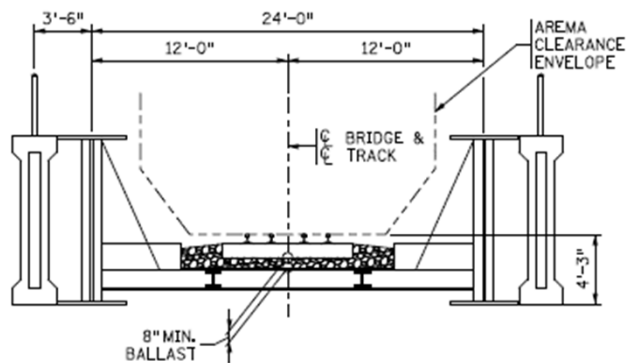

Single Span Option

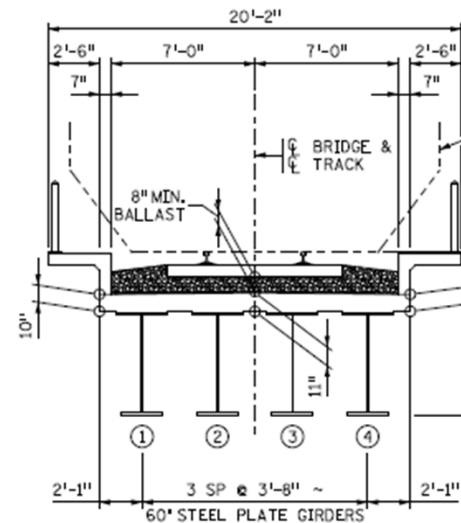

Three Span Option

Moorhead

- CMGC Moorhead Grade Separation (14017)
 - BNSF over 11th Street North
 - Could be single span or three span
 - Proposed letting January 2023

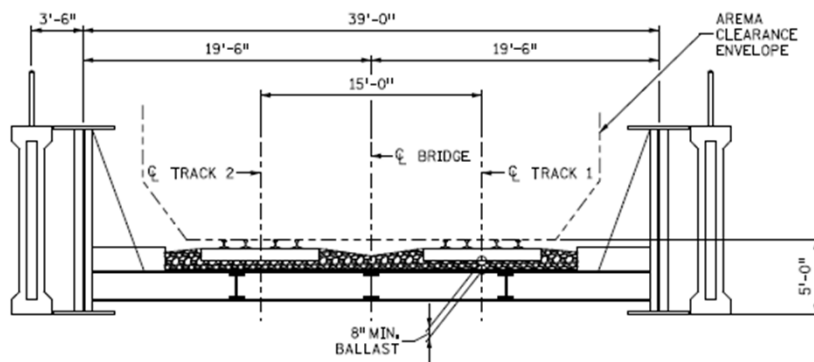

Single Span Option

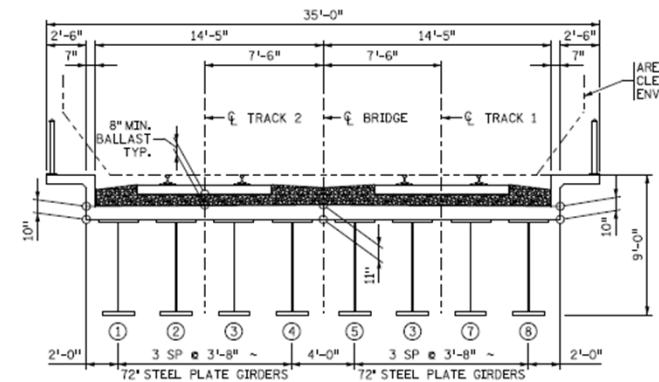

Three Span Option

- TH 243 over the St. Croix River
 - Border bridge with Wisconsin
 - 3 span welded plate girder
 - 2025 Letting

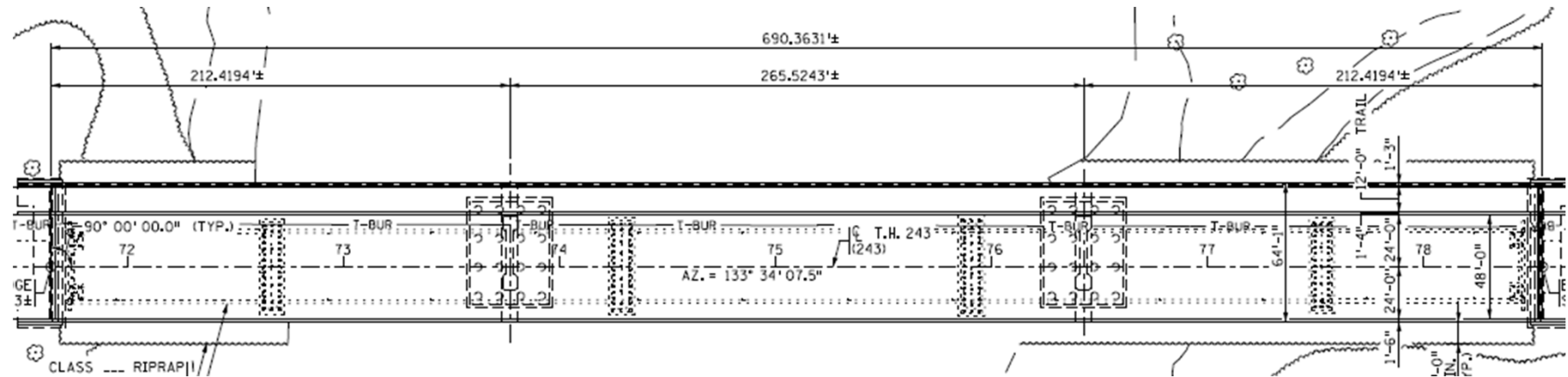
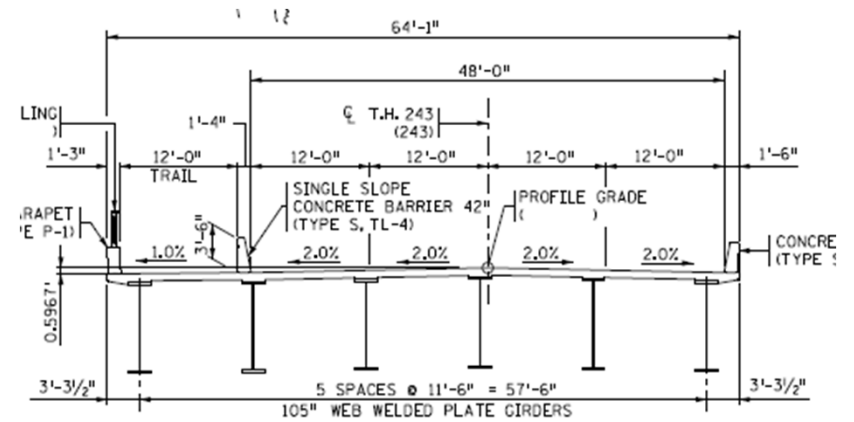

- Blatnik Bridge Replacement
 - I-535 over the St. Louis River
 - Currently, in alternative development
 - Approach spans could be plate girders

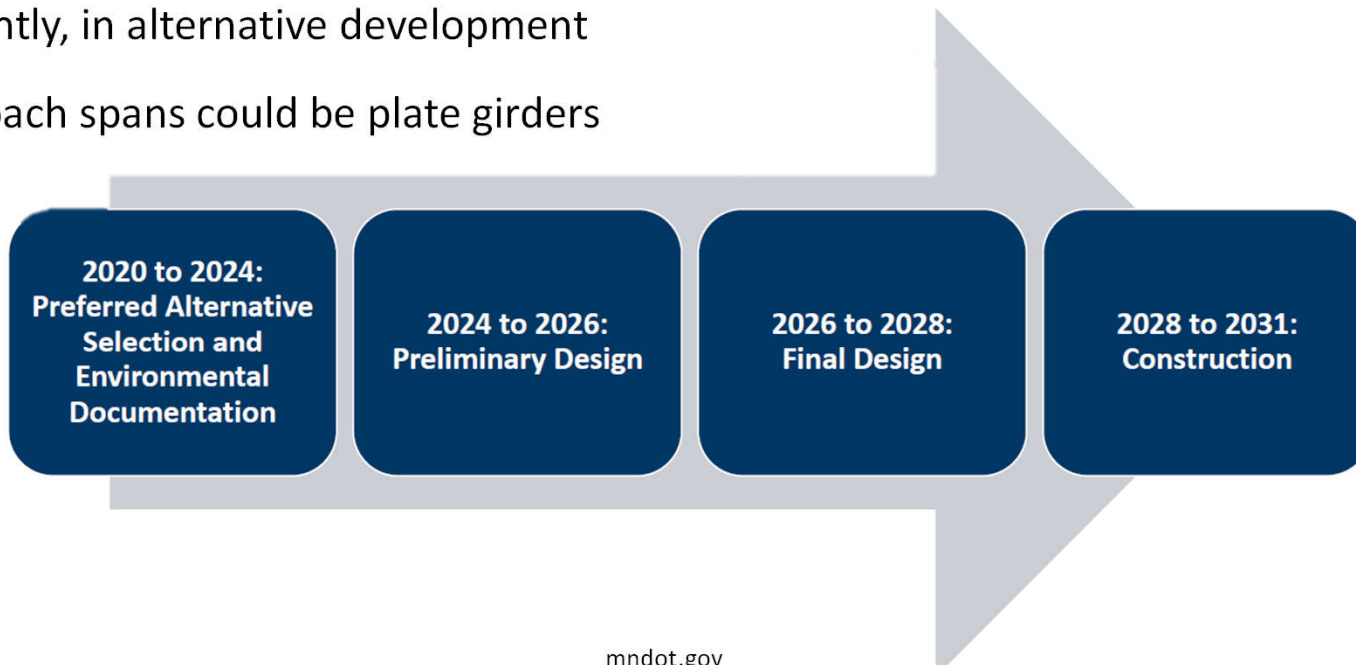

Blatnik – One of many Alternatives

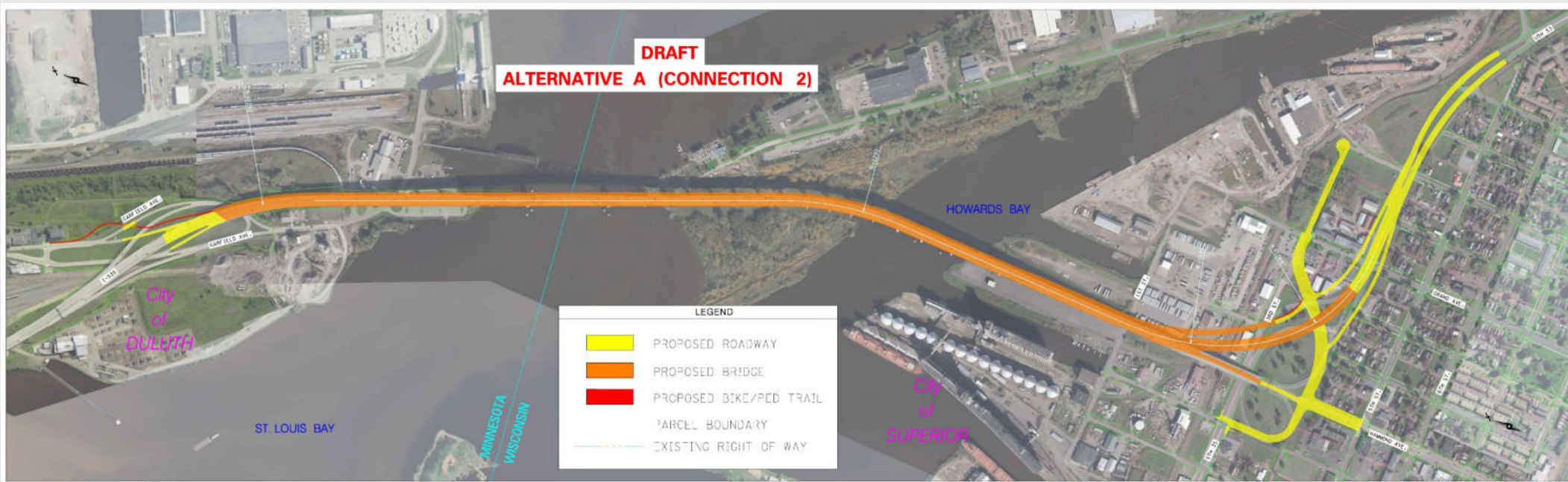

Thank You!

Kevin Western

kevin.western@state.mn.us

651-366-4501