



2022 NARIMN
CotY Awards

Kitchens
\$100-150K

Inspired Vintage

Design Statement

Category: Kitchens

\$100–150K

The kitchen in this 1920s home was substantially transformed both aesthetically and functionally. The design goals were to clear the walkway and restore the vintage details to the space.

Space planning was critical to accomplish the goals related to improve flow through the kitchen. At the mud-room the pantry shelves were redone and his and her closets were added in the room along with a landing counter capped with the accent stone.

A dated 1970s remodeling of the kitchen was tired, and the oven had stopped functioning. Covid delayed the project several times due to client infection, vendor availability, and supply chain challenges. Undaunted the team donned masks and dove in.

A unique blend of form meeting function resides in the design around the new vent hood surround. Moving the range to a wall cleared the walkway and provided for proper ventilation with the new hood insert. The original fireplace tile was the inspiration for the new tile on the hood and backsplash. Finding a matt glazed handmade tile allowed for unique profiles and multiple sizes to foster the layout design.

With the homeowner's charge of making the kitchen both beautiful and functional, the team chose stunning, yet easy to maintain materials and fixtures for the project. Enameled cabinets provide a durable finish with panels to match the original millwork in the home. The cabinets are topped with quartz counters that are accented by colorful quartzite and handmade backsplash tiles. Vintage brass light fixtures with exposed bulbs enhance the scheme, while LED tape lighting was used for counter and cooktop illumination. A speed-cook oven offers convenience with food preparation on a daily basis. Adding a charging drawer keeps the counters free of electronics too.

Challenges arose when the wood floor did not exist under peninsula that was removed. Patching this required custom making new oak floor in widths to match the existing. The square walnut plugs were another custom detail to match. Ducting the new hood required relocating water and waste pipes in the bathroom above the kitchen. Knob and tube original wiring is always a hardship to work with; it was removed whenever possible.

In the end, the homeowners now enjoy modern amenities in a space that looks like it was always there. It meets their needs of improving the performance and restoring the vintage vibe to the kitchen.



Sink wall with speedcook oven



Removing the peninsula is a game changer!





New range location





Table turned 90 degrees to clear the walkway.



Tiled vent hood = FOCAL POINT





Mudroom with closets and landing top



Inspiration Tile...



Vintage vibe fixtures

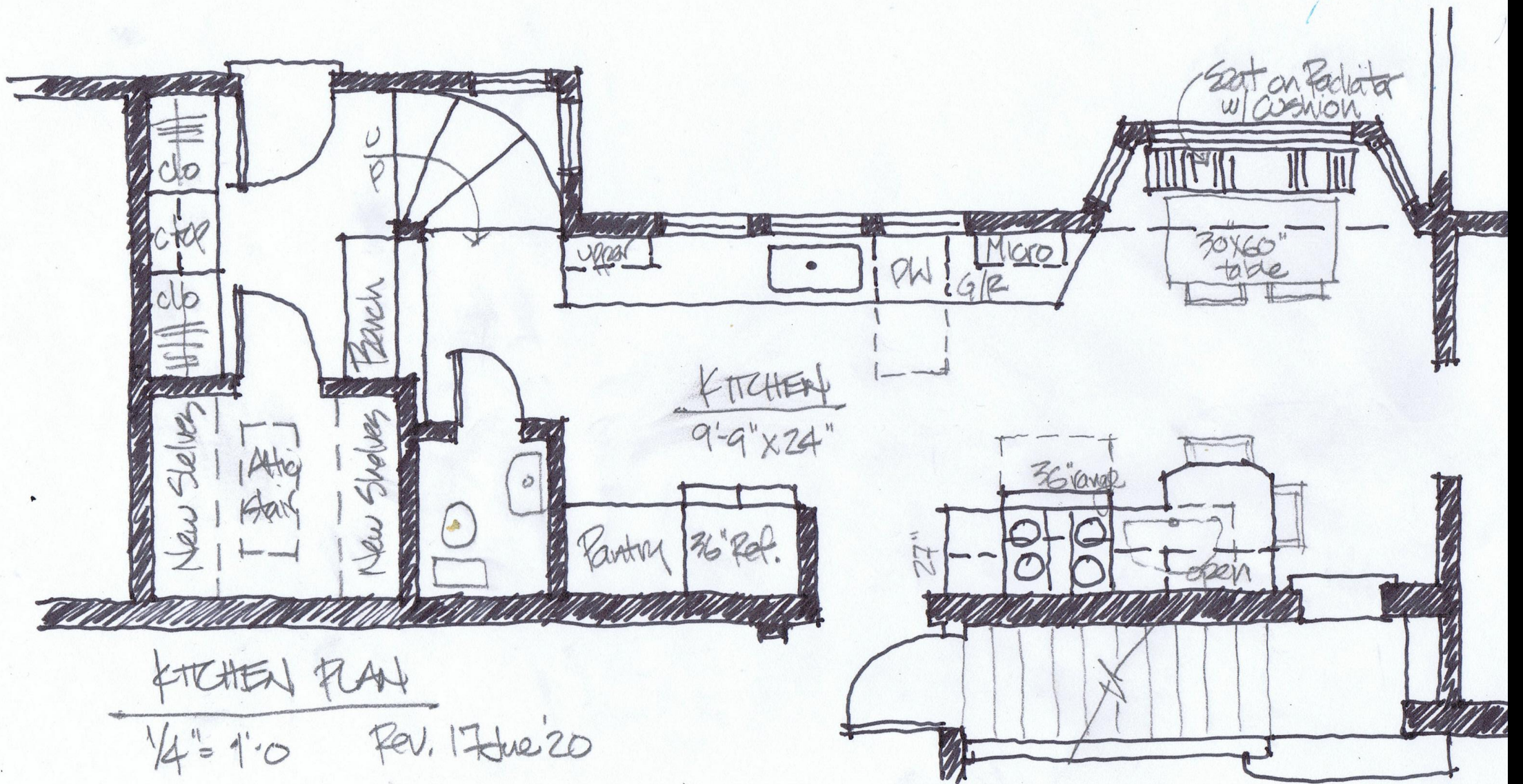

Plan



EAST FLEX. Kitchen
 $\frac{1}{4}'' = 1'-0$



WEST FLEX. Kitchen
 $\frac{1}{4}'' = 1'-0$